



JP • Group a/s

- A MEMBER OF JP GROUP AUTOMOTIVE



EXHAUSTS AND BODY PARTS FOR

PORSCHE® • Dansk®



Exhausts and body parts for Porsche®



J.P. GROUP a/s
Hjulmagervej 2
DK-8800 Viborg, Denmark
Tel.: +45 86615100/86615000
Fax: +45 86612230
www.jpgroup.dk
e-mail: sales@jpgroup.dk





...On service

- Quick and professional export delivery worldwide.
- Our packaging expertise combined with our experienced and skilled personnel, guarantee fast and reliable service. You'll not only receive your order quickly... but each product will arrive safely at your address in high quality JP packing.



...Highest quality spare parts

- at a fraction of the cost!

- The most competitive pricing policy in the automotive industry!
- The net price lists for each individual car brand are provided in excel files, with discounts based on the quantities purchased.
- Our highly skilled technical quality departments ensure a constant focus on a first class quality level.
- Global sourcing from OEM manufacturers supplying worldwide to the passenger car industry!
- Extensive engineering and R&D department developing and testing exhausts, flexible pipes, manifolds and catalytic converters.
- We produce our own products in several countries for both the OES and aftermarket spare parts for passenger cars and light commercial vehicles.

Production facilities

Our production in Denmark is 5000 m² equipped with the most modern hightech 5D laser cutting robots as well as fully automatic welding robots. We produce in aluminized, stainless and titanium materials. Most of our exhaust boxes and metal stamping parts are produced with semi-automatic hydraulic presses to insure the original design.



Test facilities

For both durability and performance testing we have our own in-house testing and service center.



Test facilities

For both durability and performance testing we have our own in-house testing and service center.

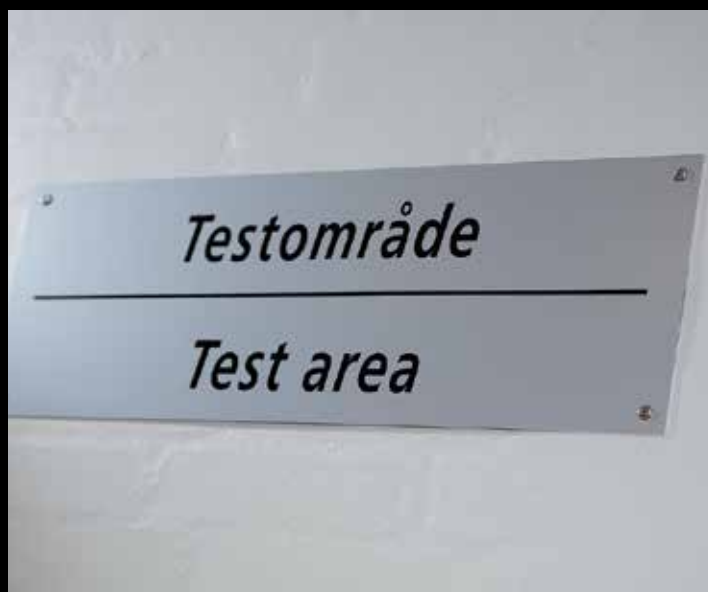

Warehouse/logistics

16000 m² modern warehouse with the new technology in picking/handling spare parts for passenger cars.



Showroom

Pictures from our 1000 m² state of the art showroom in headquarters Viborg, Denmark. For development and testing purpose, we keep most of the Porsche models produced in our showroom.



Showroom

Pictures from our 1000 m² state of the art showroom in headquarters Viborg, Denmark. For development and testing purpose, we keep most of the Porsche models produced in our showroom.

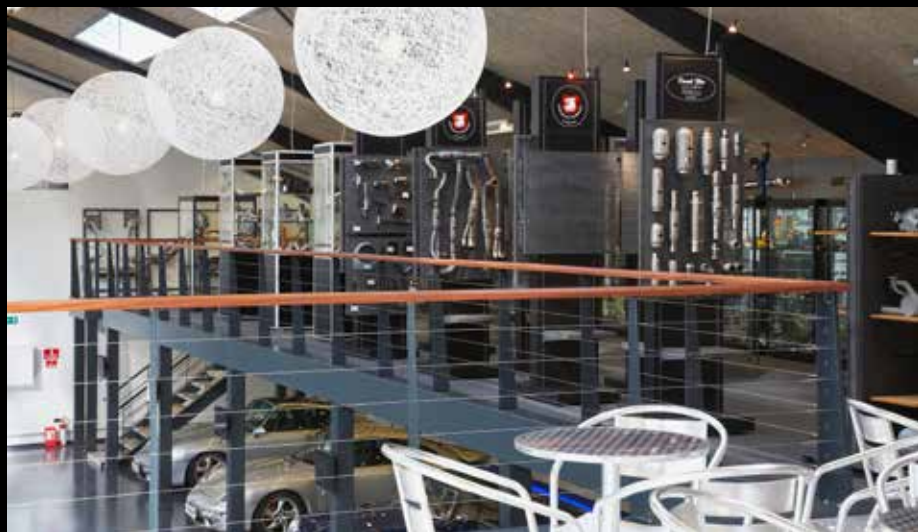

Showroom

Pictures from our 1000 m² state of the art showroom in headquarters Viborg, Denmark. For development and testing purpose, we keep most of the Porsche models produced in our showroom.



Showroom

Pictures from our 1000 m² state of the art showroom in headquarters Viborg, Denmark. For development and testing purpose, we keep most of the Porsche models produced in our showroom.



Explanation to the catalogue

This catalogue contains our original **Dansk**  program of:

-  Original style exhausts **Dansk**  ORIGINAL
-  Performance sports exhausts **Dansk**  MOTORSPORT
-  Body parts (metal stamping)
-  State of the art heat exchangers and exhausts 



High performance and original quality exhaust systems with EEC/TÜV approvals and at aftermarket prices!



Our high quality range of sports exhausts produces at your choice of painted deep draw steel or polished stainless steel. Our sports exhausts means great sound and high performance and also great look when adding our wide selection of tail pipes. Our "SOUND" systems are produces as "valve exhausts" enabling you to drive with both original alike sound, and upon using a switch, with a greater sporty sound. All produced in polished stainless steel 304 and with Pierburg quality vacuum valves.



State of the art heat exchanger and exhaust design and finish all made entirely of stainless steel AISI 304/321, meaning long life even in the severest conditions (road salt). Output is increased particularly in the low and the middle RPM ranges.

German/Danish engineering.

We are original equipment supplier to Porsche®. Dansk is an OE brand name and we produce:

Original standard. All produces according to the highest standards!

For Porsche® 356, 912, 914, 924, 944, 911 (964, 993, 996, 997), Cayenne, Boxster, Cayman and Panamera models.

Equipment, accessories and standard replacement parts.

We have a wide program of various replacement parts for Porsche®. These parts can be found in our new complete Porsche® catalogue. Please do not hesitate to ask for it!



Important notice.

This catalogue and its illustrations are not to be reproduced, in whole or in part, without special permission from J.P. Group a/s. The right is reserved to modify or discontinue the components listed and illustrated in this catalogue.



List of content

356	Model A/B/C			911	Model 993		
	Exhausts	13 -	14		Exhausts	93 -	94
	Mounting kits & tail pipes	15 -	15		Mounting kits & tail pipes	95 -	95
	Body parts	16 -	20		Body parts	96 -	97
912				911	Turbo Model 993		
	Exhausts	21 -	22		Exhausts	98 -	98
	Mounting kits & tail pipes	23 -	23		Mounting kits & tail pipes	99 -	99
914				911	Model 996		
	Exhausts	24 -	25		Exhausts	100 -	101
	Mounting kits & tail pipes	26 -	26		Mounting kits & tail pipes	102 -	102
	Body parts	27 -	28	911	Model 996 GT3		
924					Exhausts	103 -	103
	Exhausts	29 -	29		Mounting kits & tail pipes	104 -	104
944				911	Turbo Model 996		
	Exhausts	30 -	30		Exhausts	105 -	105
944	Turbo				Mounting kits & tail pipes	106 -	106
	Exhausts	31 -	31	911	Model 997-1		
911	1964-1973				Exhausts	107 -	108
	Exhausts	32 -	35		Mounting kits & tail pipes	109 -	109
	Mounting kits & tail pipes	36 -	36	911	Turbo Model 997-1		
	Body parts	37 -	46		Exhausts	110 -	110
911	1974-1977				Mounting kits & tail pipes	111 -	111
	Exhausts	47 -	50	911	Model 997-2		
	Mounting kits & tail pipes	51 -	51		Exhausts	112 -	112
	Body parts	52 -	58		Boxster Model 986		
911	1978-1989				Exhausts	113 -	115
	Exhausts	59 -	63		Mounting kits & tail pipes	116 -	116
	Mounting kits & tail pipes	64 -	64		Boxster/Cayman Model 987-I		
	Body parts	65 -	72		Exhausts	117 -	117
911	Conversion				Mounting kits & tail pipes	118 -	118
	Exhausts	73 -	74		Boxster/Cayman Model 987-II		
911	Turbo Model 930				Exhausts	119 -	119
	Exhausts	75 -	77		Cayenne		
	Mounting kits & tail pipes	78 -	78		Exhausts	120 -	121
	Body parts	79 -	85		Mounting kits & tail pipes	122 -	122
911	Model 964				Cayenne Turbo		
	Exhausts	86 -	87		Exhausts	123 -	123
	Mounting kits & tail pipes	88 -	88		Mounting kits & tail pipes	124 -	124
	Body parts	89 -	91		Variuos Exhaust Parts	125 -	125
911	Turbo Model 965			SSI			
	Exhausts	92 -	92		Exhausts	126 -	127



Exhausts

356

Model A/B/C



92.301 (1620600400)
(OE 616.111.016.05)
Rear exhaust
Painted steel
356 B model T6 Europe
356 C Europe



92.311 (1620600500)
(OE 616.111.010.05)
Rear exhaust
Painted steel
356 B/C



92.311S (1620606700)
(OE 616.111.010.05S)
Rear exhaust
Polished stainless steel 304/4301
356 B/C



92.321 (1620600700)
(OE 616.111.010.00/616.111.010.01)
Rear exhaust
Painted steel
356 A



P0-92131 (1620610200)
Rear exhaust with single tail pipe, Ø45 mm
Painted steel
356 pre-A



P0-92103 (1620603900)
(OE 616.541.03)
Rear exhaust with straight twin tail pipes, Ø45 mm
Painted steel
356 A/B/C



P0-92104 (1620603100)
Rear exhaust with straight polished stainless steel twin tail pipes, Ø63 mm. Supplied with two clamps
Painted steel
356 B/C



P0-92106 (1620610300)
Rear exhaust with twin tail pipes for bumper, Ø45 mm.
Supplied with two clamps
Painted steel
356 B/C



P0-92710 (1620100900)
Rear manifold exhaust with center tail pipe, Sebring Style.
Very loud!
Painted steel





92.001 (1623200470) left
(OE 644.211.021.00)
Heat control box
Painted steel
356 A



92.002 (1623200480) right
(OE 644.211.022.00)
Heat control box
Painted steel
356 A



92.003 (1623200570) left
(OE 644.211.025.05)
Heat control box
Painted steel
356 B/C



92.004 (1623200580) right
(OE 644.211.026.05)
Heat control box
Painted steel
356 B/C



92.221 (1623102970) left
(OE 644.211.003.00)
Heat exchanger
Painted steel
356 A/B/C



92.222 (1623102980) right
(OE 644.211.004.00)
Heat exchanger
Painted steel
356 A/B/C



92.221J (1623300170) left
J-tube
Painted steel
356 A/B/C



92.222J (1623300180) right
J-tube
Painted steel
356 A/B/C





Mounting Kits & Tail pipes

356

Model A/B/C



92.302 (1620701410)
(OE 616.111.005.00)
Tail pipe set
Painted aluminized steel
356 A



92.303 (1620701510)
(OE 616.111.006.60)
Tail pipe set
Painted aluminized steel
356 B model T5 Europe
356 B/C export USA



92.303S (1620704910)
(OE 616.111.006.60S)
Tail pipe set
Stainless steel 304/4301
356 B model T5 Europe
356 B/C export USA

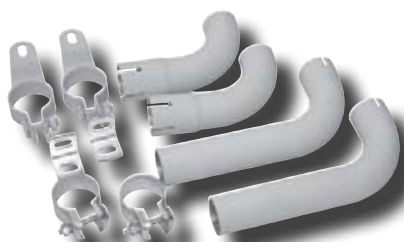

92.304 (1620701610)
(OE 616.111.007.00)
Tail pipe set
Painted aluminized steel
356 B model T6 Europe
356 C Europe



92.304S (1620705010)
(OE 616.111.007.00S)
Tail pipe set
Stainless steel 304/4301
356 B model T6 Europe
356 C Europe



92.900S (1620704800)
(OE 901.111.245.01S)
Tail pipe, 50.5 x 170 x 60 mm. Suitable for
PO-92103
Polished stainless steel 304/4301
356 A/B/C



92.901S (1620703800)
Tail pipe trim in bumper horn (2 pcs. needed)
Fits PO-92106
Polished stainless steel 304/4301
356 B/C



92.910S (1620703710)
Tail pipe set. Suitable for PO-9104
Polished stainless steel 304/4301
356 B/C





571011

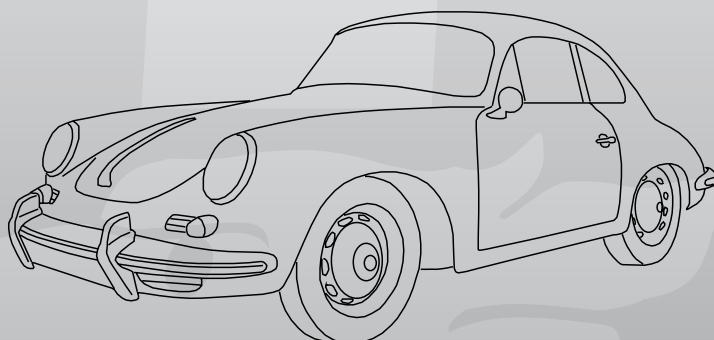

571041/571042

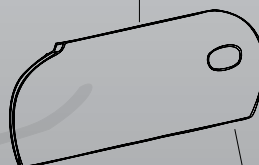

571013/571014

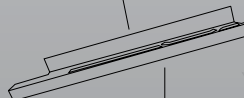

571013-1/571014-1



571075/571076



571079-2



571079-1



571077/571078



571080





Body Parts

356

Model A/B/C

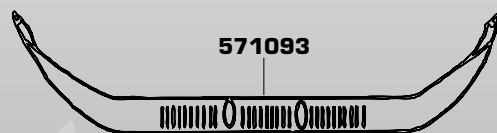
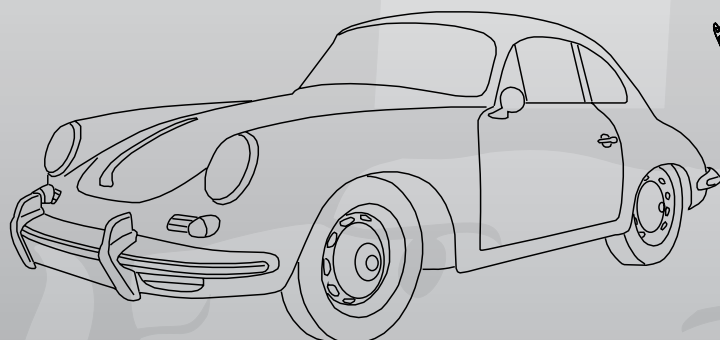

571071-1

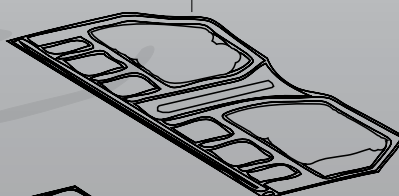

571071-2

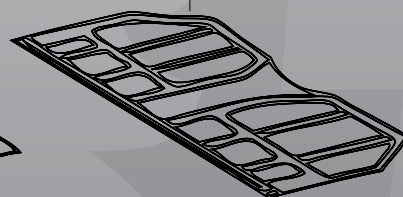

571071-0

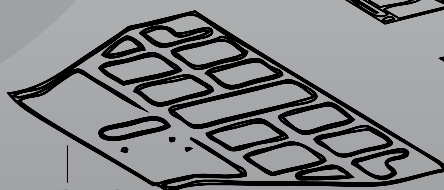

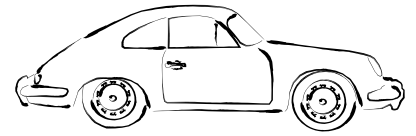

571000-8 (1615600300)
(OE 35.656.012)
Fuel tank, OE version
356 A/B T5
Painted steel

571100-8 (1615600400)
(OE 644.201.001.07)
Fuel tank, OE version
356 B T6/C
Painted steel

571011 (1682000100) left/right
(OE 644.631.151.00)
Headlight bucket
Fits European and US headlamps
356 A/B/C
Painted steel



571013 (1680900470) left
Bottom plate for door
356 A/B
Painted steel

571014 (1680900480) right
Bottom plate for door
356 A/B
Painted steel

571013-1 (1680900370) left
Bottom plate for door
356 C
Painted steel



571014-1 (1680900380) right
Bottom plate for door
356 C
Painted steel

571041 (1680900170) left
(OE PCG.531. 003.05)
Complete door skin
356 A/B/C
Painted spcc steel

571042 (1680900180) right
(OE PCG.531. 004.05)
Complete door skin
356 A/B/C
Painted spcc steel



Body Parts

356

Model A/B/C



571071-0 (644.501.052.00)
Floor pan, front, without mounts
356 A/B/C
Painted steel



571071-1 (1683100400)
(OE 644.501.050.00)
Floor pan, rear, without mounts
356 A
Painted steel



571071-2 (1683100500)
(OE 644.501.053.00)
Floor pan, rear, without mounts
356 B/C
Painted steel



571075 (1681000170) left
(OE 644.503.041.00)
Outer door panel
356 A/B/C
Painted steel



571076 (1681000180) right
(OE 644.503.042.00)
Outer door panel
356 A/B/C
Painted steel



571077 (1682500170) left
(OE 644.501.017.00)
Inner rocker panel without jack support
356/A
Painted steel



571078 (1682500180) right
(OE 644.501.018.00)
Inner rocker panel without jack support
356/A
Painted steel



571079-1 (1682200100) left
(OE 644.502.261.05)
Reinforcement side member
356 A/B/C
Painted steel

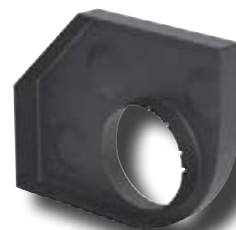

571079-2 (1682200200) right
(OE 644.501.261.06)
Reinforcement side member
356 A/B/C
Painted steel

Body Parts

356

Model A/B/C



571080 (1681700100)
(OE 644.501.150.00)
Jack receiver bracket
356 A/B/C
Painted steel

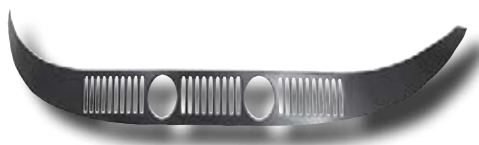

571093 (1680600100)
(OE 644.54.104)
Lower rear panel with louvres. Used when fitting
sport rear box no. P0-92103 or P0-92104
356 B/C
Painted steel



Exhausts

912

1965-1969



92.311 (1620600500)
(OE 616.111.010.05)
Rear exhaust
Painted steel
912 export USA



92.311S (1620606700)
(OE 616.111.010.05S)
Rear exhaust
Polished stainless steel 304/4301
912 export USA



92.301 (1620600400)
(OE 616.111.016.05)
Rear exhaust
Painted steel
912 Europe



PO-92105 (1620603200)
Rear exhaust with straight polished stainless
steel twin tail pipes, Ø63 mm. Supplied with two
clamps
Painted steel
912 export USA



92.221J (1623300170) left
J-tube
Painted steel
912 Europe and USA



92.222J (1623300180) right
J-tube
Painted steel
912 Europe and USA



92.223 (1623103070) left
(OE 616.211.003.01)
Heat exchanger
Painted steel
912 Europe and USA



92.224 (1623103080) right
(OE 616.211.004.01)
Heat exchanger
Painted steel
912 Europe and USA



90.001 (1623200270) left
(OE 901.211.007.22)
Heat control box
Painted steel
912 Europe and USA



Exhausts

912

1965-1969



90.002 (1623200280) right
(OE 901.211.008.22)
Heat control box
Painted steel
912 Europe and USA





Mounting Kits & Tail Pipes

912

1965-1969



92.312 (1620701310)

(OE 616.111.298.00)

Tail pipe kit

Painted steel

912 Europe and USA

92.313 (1620400300)

(OE 616.111.028.00)

Connecting piece for exhaust

Painted steel

912 Europe and USA



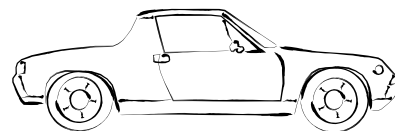

91.403 (1620000400)

(OE 021.251.053C)

Rear exhaust including tail pipe and mounting kit
Painted steel

914/4, 1.7-1.8 eng., 69-75



91.405 (1620600200)

(OE 901.111.011.11)

Rear exhaust, Ø60 mm loose outlet pipe in
polished stainless steel 304/4301

Box in painted aluminized steel

914/6, 2.0 6 cyl. eng., 70-73



91.406 (1620600300)

(OE 039.251.051D)

Rear exhaust, Ø48 mm loose outlet pipe in
polished stainless steel 304/4301

Box in painted aluminized steel

914/4, 2.0 eng., 72-75



91.407 (1620604800)

Rear exhaust with two Ø70 mm tail pipes in
polished stainless steel 304/4301

Can only be used in connection with 91.415/416

Box in painted aluminized steel

Rear valance must be modified

914/4, 1.7-1.8 eng., 69-75



91.408 (1620604600)

Rear exhaust with two Ø76 mm centre tail pipes in
polished stainless steel 304/4301

Can only be used in connection with 91.415/416

Box in painted aluminized steel

Rear valance must be modified

914/4, 1.7-1.8 eng., 69-75



91.409 (1620604700)

Rear exhaust with two Ø76 mm centre tail
pipes in polished stainless steel 304/4301

Box in painted aluminized steel

Rear valance must be modified

914/4, 2.0 eng., 72-75



92.214 (1620607100)

Rear racing exhaust with two Ø70 mm centre
tail pipes. No street use!. Has to be used
together with 92.215

Painted steel

914/6, 2.0 eng., 70-73



92.215 (1620401210)

Racing tubes from heat exchanger to exhaust.

No street use!

For 92.214

Painted steel

914/6, 2.0 eng., 70-73



91.401 (1623200370) left

(OE 022.256.205A)

Heat control box

Painted steel

914/4, 1.7-1.8 eng., 69-75



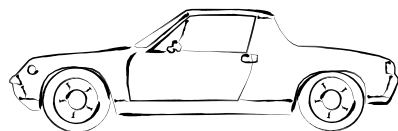

Exhausts

914

1969-1975



91.402 (1623200380) right
(OE 022.256.206A)
Heat control box
Painted steel
914/4, 1.7-1.8 eng., 69-75



1969-1975

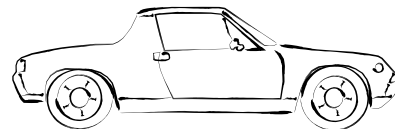

VW-35208 (1121700710)
(OE 021.198.001)
Exhaust mounting kit for 91.403
914/4, 1.7-1.8 eng., 69-75

91.404 (1620700900)
(OE 021.251.185C)
Tail pipe for 91.403
Painted steel
914/4, 1.7-1.8 eng., 69-75



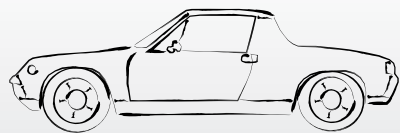

Body Parts

914

1969-1975

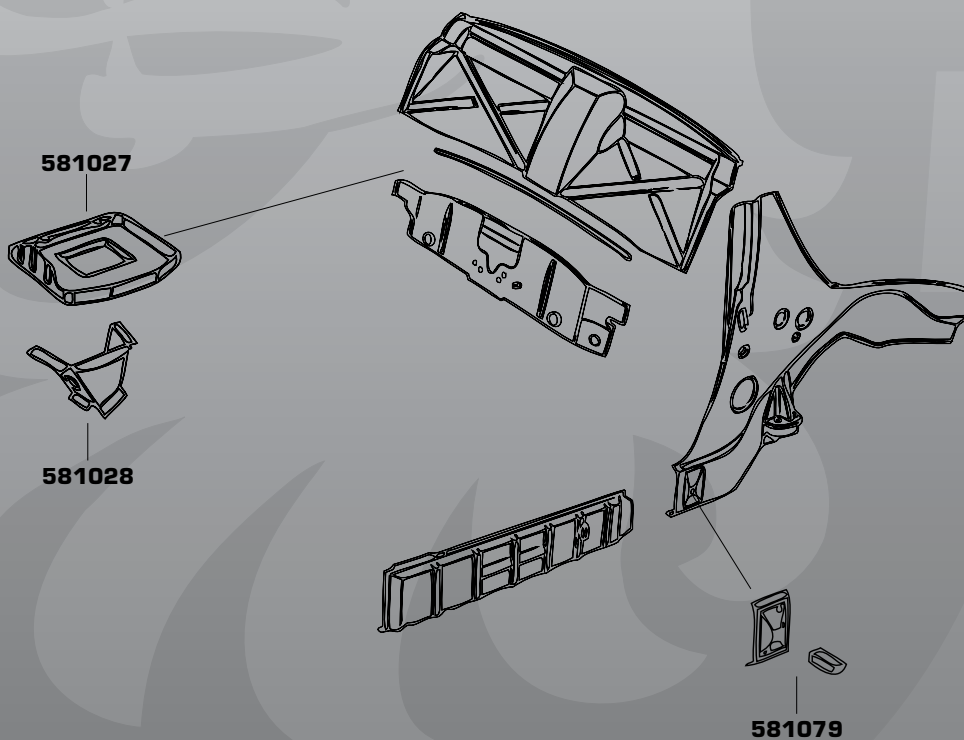
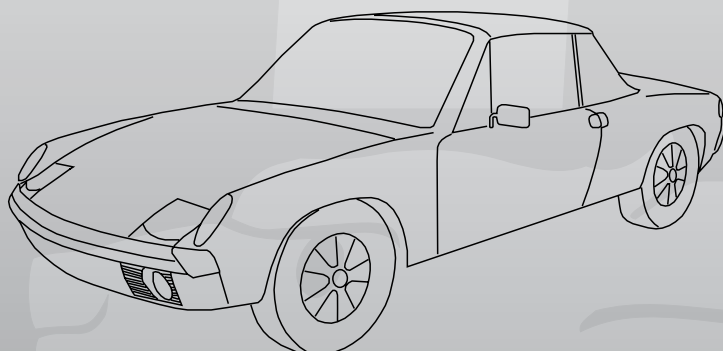

1969-1975

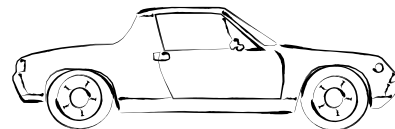

581027 (1682700100)
(OE 914.501.587.10)
Battery tray
Painted steel



581028 (1682700200)
(OE 914.501.073.10)
Support for battery tray
Painted steel



581079 (1681700200)
(OE 914.501.151.10)
Jack support plate and tube
Painted steel



Exhausts

924

2.0-2.5 L, 1977-1988



92.401S (1620200400)
(OE 477.253.101G)
Front pipe
Stainless steel 304/4301 (non polished)
2.0 eng., 76-85



92.403BS (1620608300)
(OE 477.253.125K)
Rear exhaust
Polished stainless steel 304/4301
2.0 eng., 76-85



VW-35291 (1120501500)
(OE 443.253.119A)
Intermediate exhaust
Aluminized steel
2.0 eng., 76-85



92.445S (1620500100)
(OE 944.111.985.01)
Intermediate exhaust
Polished stainless steel 304/4301
2.5 8V eng., 86-88
With TÜV/EEC approval



92.440S (1620606000)
(OE 944.111.083.01)
Rear sport exhaust
Polished stainless steel 304/4301
2.5 eng., 86-88 (924 S model)
With TÜV/EEC approval



92.442S (1620608600)
(OE 944.111.041.03)
Rear sport exhaust
Polished stainless steel 304/4301
2.5 eng., 87-88 (924 S model)



Exhausts

944/S/S2

2.5-3.0 L, 1982-1991

Not turbo



92.445S (1620500100)
(OE 944.111.985.01)
Intermediate exhaust
Polished stainless steel 304/4301
2.5-2.7 8V eng., 85-89
With TÜV/EEC approval



92.440S (1620606000)
(OE 94411108301)
Rear sport exhaust
Polished stainless steel 304/4301
2.5 eng., 82-91 (eng. M44.01-08 + M44.10)
2.7 eng., 89-91 (eng. M44.12)
With TÜV/EEC approval



92.442S (1620608600)
(OE 944.111.041.03)
Rear sport exhaust
Polished stainless steel 304/4301
2.5 eng., 87-88 (eng. M44.09 + M44.40)
2.7 eng., 89-91 (eng. M44.11)
3.0 eng., 89-91 (eng. M44.41)





Exhausts

944 TURBO

2.5 L, 1986-1991



92.441S (1620608500)
(OE 951.111.083.01)
Rear sport exhaust
Polished stainless steel 304/4301



Exhausts

911 T/E/S



2.0-2.4 L, 1964-1973

Pre-impact bumper models, 2 inlet exhausts



92.210 (1620607600)
(OE 911.111.025.00)
Rear exhaust, Ø60 mm tail pipe
Painted aluminized steel
With TÜV/EEC approval



92.2100E (1620609000)
(OE 911.111.025.00)
Rear exhaust, Ø60 mm tail pipe in polished
stainless steel. OE specifications
Box in painted stainless steel 304/4301
With TÜV/EEC approval



92.210S (1620607800)
(OE 911.111.025.00)
Rear exhaust, Ø60 mm tail pipe
Polished stainless steel
With TÜV/EEC approval



92.510 (1620605300)
Rear exhaust, 2 in - 1 out, Ø70 mm tail pipe in
polished stainless steel 304/4301
Box in painted aluminized steel
With TÜV/EEC approval



92.510DUAL (1620605800)
Rear exhaust, 2 in - 2 out, Ø50 mm centre tail
pipes. 2 x 92.900S can be fitted as stainless
steel tail pipes (easy mount on type)
Painted aluminized steel



92.510DUALS (1620605700)
Rear exhaust, 2 in - 2 out, Ø50 mm centre tail
pipes. 2 x 92.900S can be fitted as stainless
steel tail pipes (easy mount on type)
Polished stainless steel



92.510S (1620603400)
Rear exhaust, 2 in - 1 out, Ø70 mm tail pipe
Polished stainless steel 304/4301
With TÜV/EEC approval



92.510SD (1620604000)
Rear exhaust, 2 in - 2 out, Ø70 mm tail pipes
Polished stainless steel 304/4301
With TÜV/EEC approval



92.510SL (1620603600)
Rear exhaust, single Ø70 mm loose tail pipe
(weld on type)
Polished stainless steel 304/4301
With TÜV/EEC approval



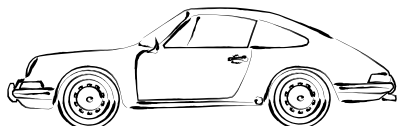

Exhausts

911 T/E/S

2.0-2.4 L, 1964-1973

Pre-impact bumper models, 2 inlet exhausts



92.510SDL (1620604200)

Rear exhaust, double Ø70 mm loose tail pipes (weld on type)
Polished stainless steel 304/4301
With TÜV/EEC approval



92.515DUAL (1620610700)

Rear exhaust, 2 in - 2 out, Ø60 mm centre tail pipes.
Painted aluminized steel



92.520DUAL (1620610000)

Rear exhaust, double Ø76 mm polished stainless steel tail pipes
Painted steel



92.212 (1620607000)

Rear exhaust, no street use. 92.213 needed for fitting the exhaust on 91.019S and 91.020S. Ø 70 mm tail pipes
Painted steel



92.213 (1620401110)

Exhaust tubes to connect exhaust box 92.212 to racing heat exchangers 91.019S/91.020S
Painted steel



91.014 (1620800470) left

Exhaust racing tube without heating function, Ø 38 mm outside. Replacing heat exchanger 91.011
Painted chrome steel 409/4512



91.015 (1620800480) right

Exhaust racing tube without heating function, Ø 38 mm outside. Replacing heat exchanger 91.012
Painted chrome steel 409/4512



91.019S (1623101970) left

Exhaust racing heat exchanger without heating function, Ø45 mm outside. Fits 92.212 directly with use of exhaust tubes 92.213. 91.021S needed for use with standard exhausts
Stainless steel 304/4301



91.020S (1623101980) right

Exhaust racing heat exchanger without heating function, Ø45 mm outside. Fits 92.212 directly with use of exhaust tubes 92.213. 91.021S needed for use with standard exhausts
Stainless steel 304/4301



Exhausts

911 T/E/S

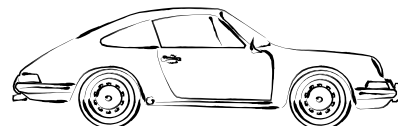

2.0-2.4 L, 1964-1973

Pre-impact bumper models, 2 inlet exhausts



91.021S (1620400110)

Exhaust tube set, connecting racing heat exchangers 91.019S/91.020S to standard exhaust with 2 inlets

Stainless steel 304/4301

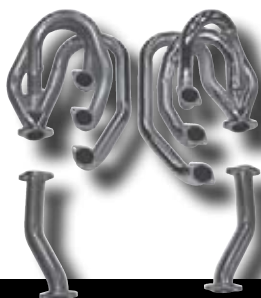

91.022S (1620101010)

Racing header set with pipes to connect to standard exhaust with 2 inlets. Ø45 mm outside

Stainless steel 304/4301



91.011 (1623102370)* left

(OE 911.211.021.60)

Heat exchanger

Painted aluminized steel

* Not for mechanical injection models

Dansk
MOTORSPORT

Dansk
MOTORSPORT

Dansk
ORIGINAL



91.012 (1623102380) right

(OE 911.211.022.10)

Heat exchanger

Painted aluminized steel



91.011S (1623102570)* left

(OE 911.211.021.60)

Heat exchanger

Polished stainless steel 304/4301

* Not for mechanical injection models



91.012S (1623102580) right

(OE 911.211.022.10)

Heat exchanger

Polished stainless steel 304/4301

Dansk
ORIGINAL

Dansk
ORIGINAL

Dansk
ORIGINAL



91.013 (1623102670)* left

(OE 911.211.021.14)

Heat exchanger

Painted aluminized steel



91.013S (1623102770)* left

(OE 911.211.021.14)

Heat exchanger

Polished stainless steel 304/4301

* For mechanical injection models



90.001 (1623200270) left

(OE 901.211.007.22)

Heat control box

Painted aluminized steel

Dansk
ORIGINAL

Dansk
ORIGINAL

Dansk
ORIGINAL



Exhausts

911 T/E/S

2.0-2.4 L, 1964-1973

Pre-impact bumper models, 2 inlet exhausts



90.002 (1623200280) right
(OE 901.211.008.22)
Heat control box
Painted aluminized steel

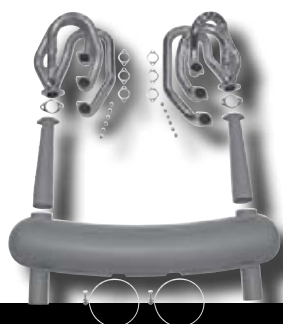

92.291 (1620000610)
Racing exhaust system with racing heat exchangers (no heating). Two racing outlet tubes Ø70 mm. Grey painted. Contains:
1x92.212, 1x92.213, 1x91.019S, 1x91.020S,
1x91.020S, 2x901.111.193.00, 2x901.111.157.04
6x930.111.191.12 and 12x999.085.001.02



92.292S
Sport exhaust system with racing heat exchangers (no heating). Polished stainless steel.
2.0-2.7 eng.
Contains: 1x92.510S, 1x91.019S, 1x91.020S,
1x91.021S, 2x901.111.193.00, 2x901.111.157.04,
6x930.111.191.12 and 12x999.085.001.02

Dansk
ORIGINAL

Dansk
MOTORSPORT

Dansk
MOTORSPORT

Mounting Kits & Tail Pipes

911 T/E/S

2.0-2.4 L, 1964-1973

Pre-impact bumper models, 2 inlet exhausts



91.011KIT (1621701410)
Mounting kit for heat exchanger
Fits 91.011, 91.011S, 91.012, 91.012S,
91.013 and 91.013S

92.900S (1620704800)
(OE 901.111.245.01)
Tail pipe, 50.5 x 170 x 60 mm
Polished stainless steel 304/4301

901.111.245.01 (1620700500)
(OE 901.111.245.01)
Exhaust tip, push on type
Chromed stainless steel 304/4301



911.111.245.00 (1620700400)
(OE 911.111.245.00)
Exhaust tip, push on type
Black painted steel

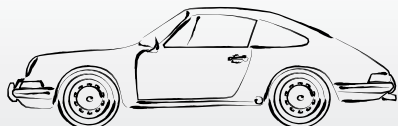

Body Parts

911 T/S

Pre-impact bumper models, 2 inlet exhausts
2.0-2.4 L, 1964-1968

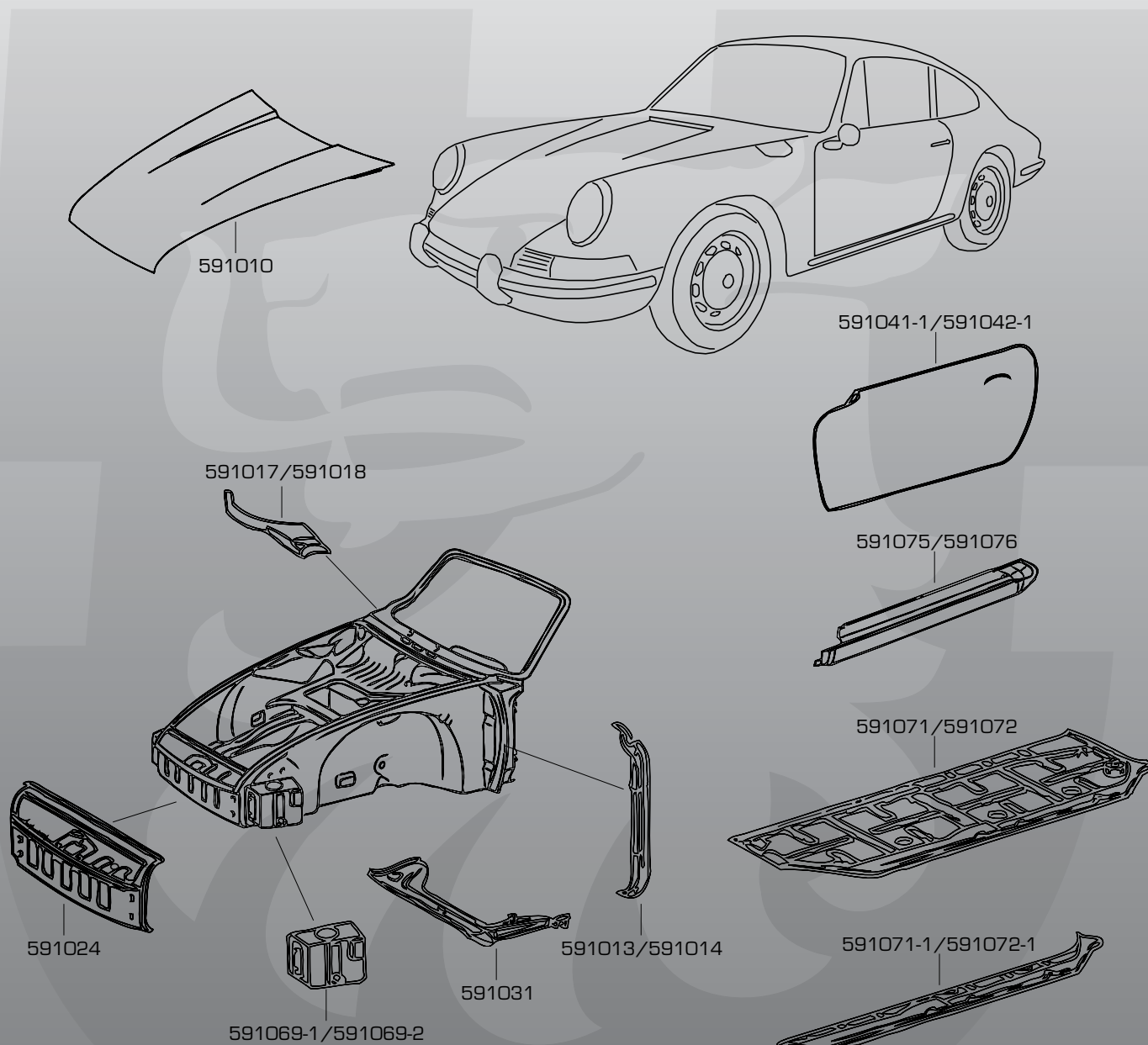



Pre-impact bumper models, 2 inlet exhausts
2.0-2.4 L, 1964-1968

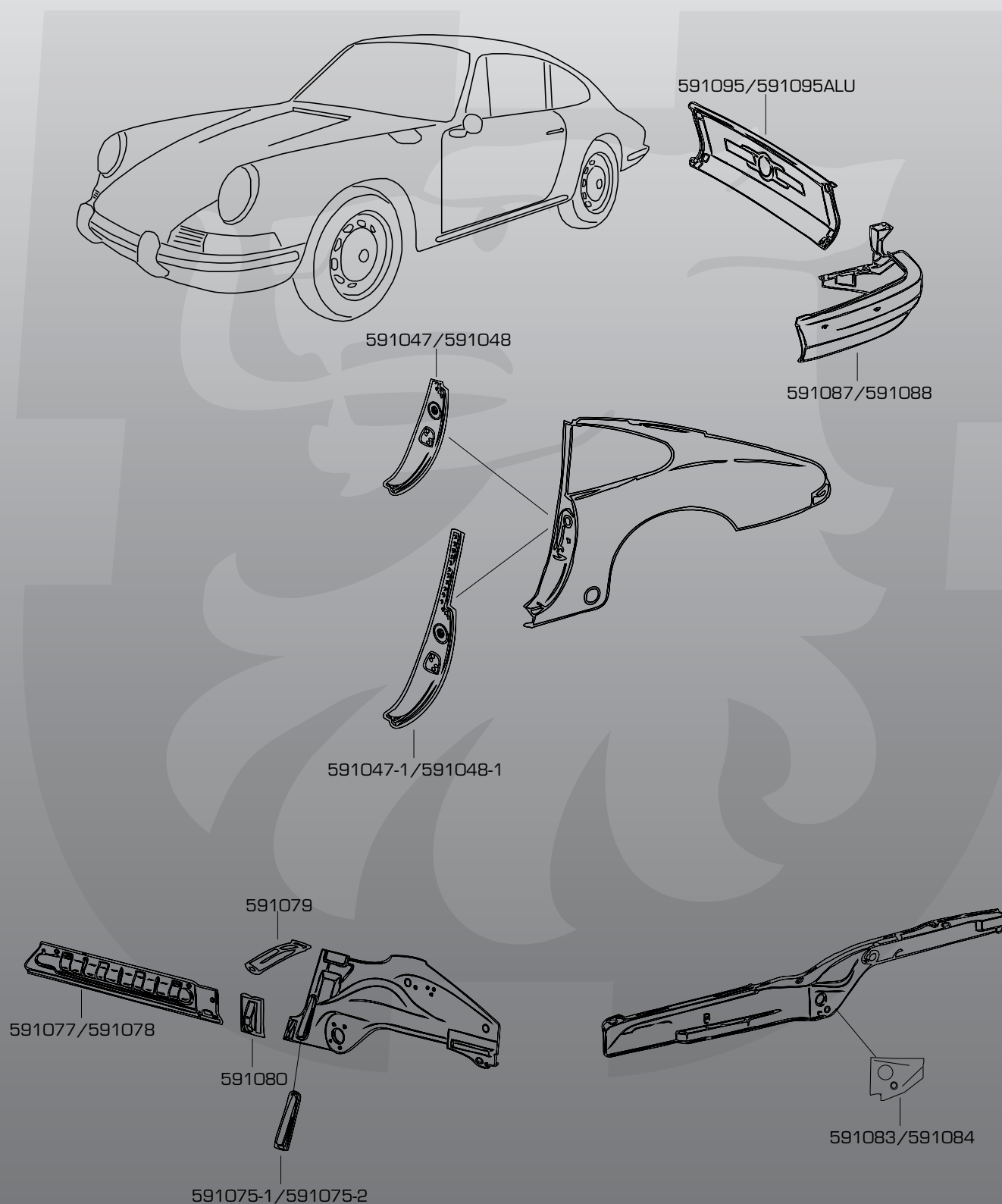

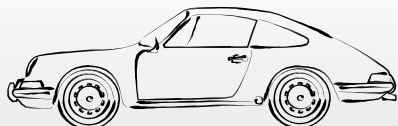

Body Parts

911 T/E/S

2.0-2.4 L, 1969-1973

Pre-impact bumper models, 2 inlet exhausts

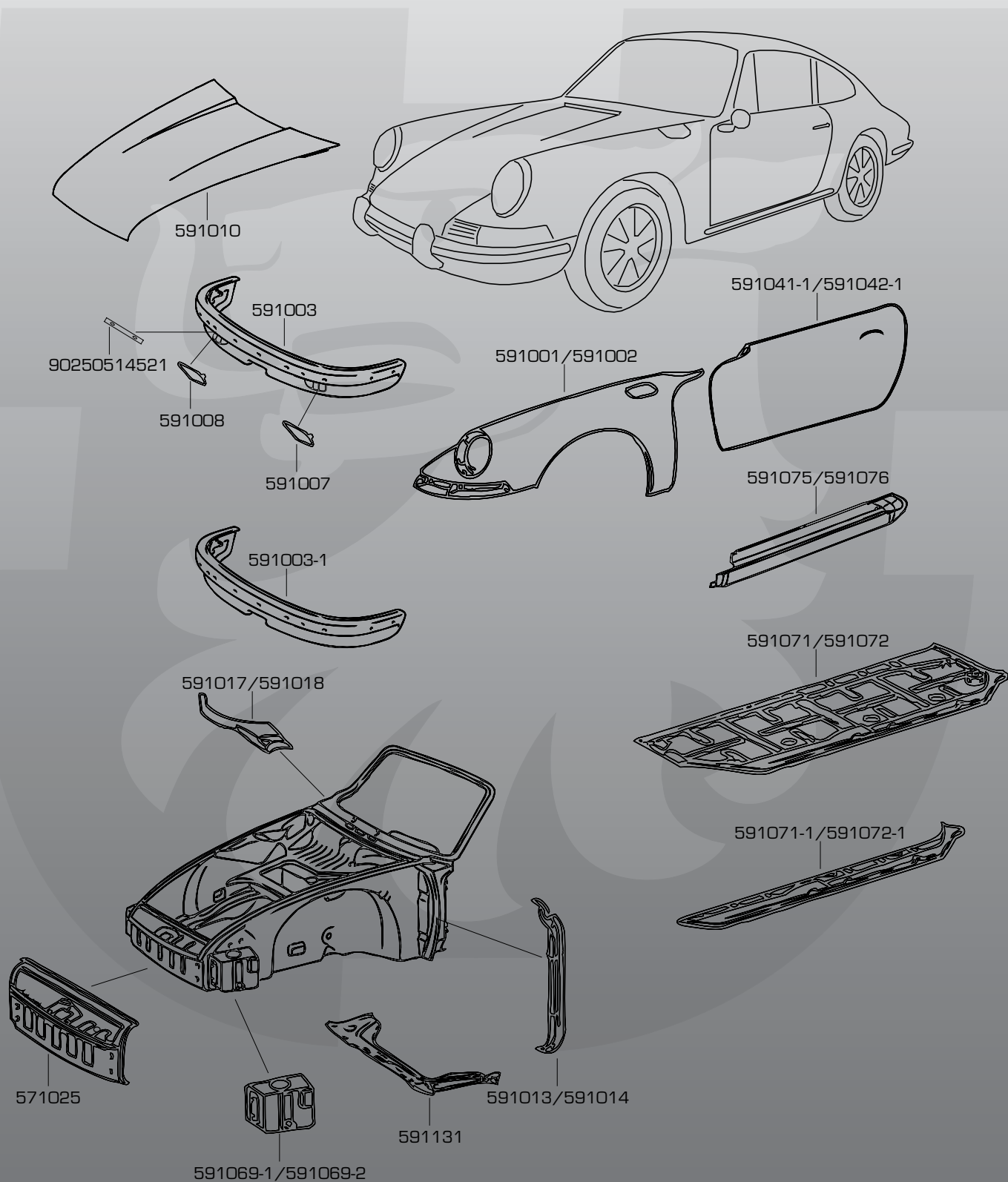



2.0-2.4 L, 1969-1973

Pre-impact bumper models, 2 inlet exhausts

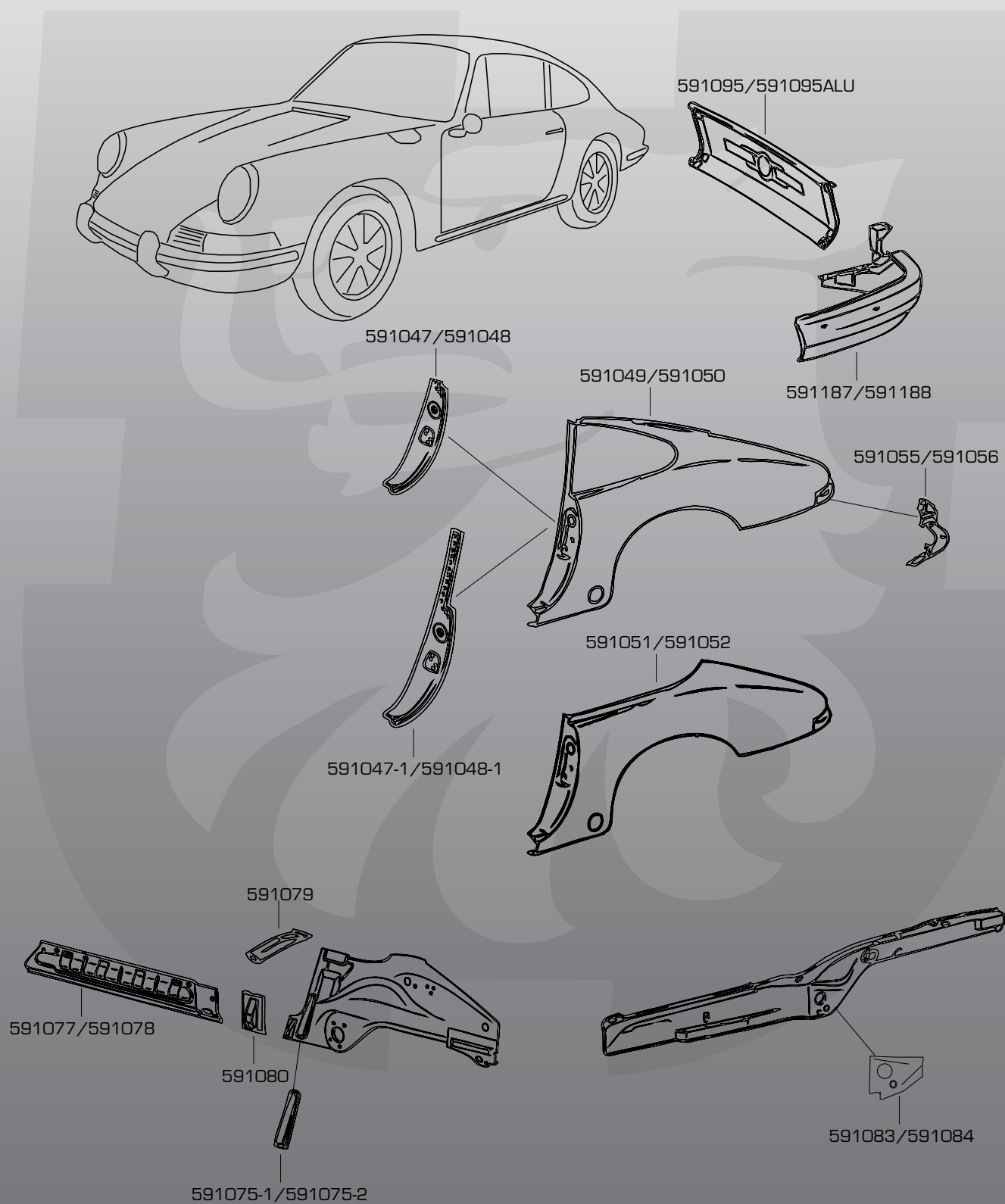

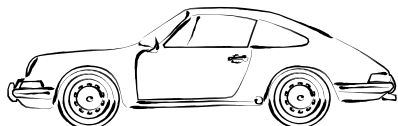

Body Parts

911 T/E/S

2.0-2.4 L, 1964-1973

Pre-impact bumper models, 2 inlet exhausts



91120190400 (1615600100)
(OE 911.201.904.00)
Fuel tank (without inside baffle), 62 L
Painted steel



93020101002 (1615600200)
(OE 930.201.010.02)
Fuel tank (without inside baffle), 85 L
Painted steel



591001 (1680300170) left
(OE 901.503.031.23)
Front fender
69-73
Painted spcc steel



591002 (1680300180) right
(OE 901.503.032.23)
Front fender
69-73
Painted spcc steel



591003 (1684100400)
(OE 911.505.011.05GRV)
Bumper with hole for fog light, front
69-73
Painted spcc steel, 1.6 mm



591003-1 (1684100500)
(OE DAN.505.011.05GRV)
Bumper without hole for fog light, front
69-73
Painted spcc steel, 1.6 mm



591007 (1684150170) left
(OE 902.505.055.21GRV)
Cover for fog lamp hole
68-73
Painted spcc steel



591008 (1684150180) right
(OE 902.505.056.21GRV)
Cover for fog lamp hole
68-73
Painted spcc steel



90250514521 (1684150200)
(OE 902.505.145.21)
Retaining bar for cover, fog lamp
Spcc Steel



2.0-2.4 L, 1964-1973

Pre-impact bumper models, 2 inlet exhausts



591010 (1680100100)
(OE 901.511.010.20)
Bonnet
Painted steel



591013 (1682300270) left
(OE 911.501.053.00)
Fender joining plate
Painted aluminized steel



591014 (1682300280) right
(OE 911.501.054.00)
Fender joining plate
Painted aluminized steel



591017 (1684000170) left
(OE DAN.503.087.42)
Repair piece for windshield frame
Painted aluminized steel



591018 (1684000180) right
(OE DAN.503.088.42)
Repair piece for windshield frame
Painted aluminized steel



591024 (1680500100)
(OE 901.501.031.20)
Cross panel
64-67
Painted aluminized steel



591025 (1680500200)
(OE 901.501.031.21)
Cross panel with hole for washer tank
68-73
Painted aluminized steel



591031 (1682700300)
(OE 901.501.049.20)
Fuel tank and battery support
64-69
Painted aluminized steel



591041-1 (1680900270) left
(OE DAN.531.005.22)
Complete door skin
Painted galvanized steel

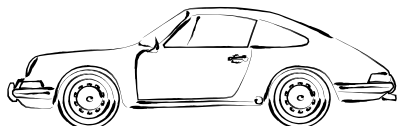

Body Parts

911 T/E/S

2.0-2.4 L, 1964-1973

Pre-impact bumper models, 2 inlet exhausts



591042-1 (1680900280) right
(OE DAN.531.006.22)
Complete door skin
Painted galvanized steel



591047 (1681900170) left
(OE 911.502.041.04)
Door jamb
Please note that the area around the rear deck
lid is different on 64-69 models
Painted aluminized steel



591048 (1681900180) right
(OE 911.502.042.04)
Door jamb
Painted aluminized steel



591047-1 (1681900270) left
(OE 964.502.041.00)
Door jamb, complete with quarter window frame
part
Please note that the area around the rear deck
lid is different on 64-69 models
Painted spcc steel



591048-1 (1681900280) right
(OE 964.502.042.00)
Door jamb, complete with quarter window frame
part
Painted spcc steel



591049 (1680400370) left
(OE 911.503.061.00)
Quarter panel
Coupé, 69-73
Painted spcc steel



591050 (1680400380) right
(OE 911.503.062.00)
Quarter panel
Coupé, 69-73
Painted spcc steel



591051 (1680400470) left
(OE 911.503.061.40)
Quarter panel
Targa, 69-73
Painted spcc steel



591052 (1680400480) right
(OE 911.503.062.43)
Quarter panel
Targa, 69-73
Painted spcc steel



2.0-2.4 L, 1964-1973

Pre-impact bumper models, 2 inlet exhausts



591055 (1680600570) left
(OE 901.503.073.23)
Rear light support
Coupé, 69-73
Painted spcc steel

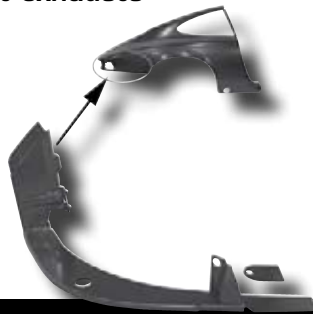

591056 (1680600580) right
(OE 901.503.074.23)
Rear light support
Coupé, 69-73
Painted spcc steel



591069-1 (1682700570) left
(OE 901.501.503.00)
Battery box
Painted steel



591069-2 (1682700580) right
(OE 901.501.504.00)
Battery box
Painted steel



591071 (1683100170) left
(OE 911.501.935.00)
Complete floor
Painted aluminized steel



591072 (1683100180) right
(OE 911.501.936.00)
Complete floor
Painted aluminized steel



591071-1 (1683100670) left
(OE DAN.501.935.00)
Floor pan outer repair section, 180 mm
Painted aluminized steel



591072-1 (1683100680) right
(OE DAN.501.936.00)
Floor pan outer repair section, 180 mm
Painted aluminized steel



591075 (1681000370) left
(OE 911.503.401.04)
Door panel
Painted galvanized steel

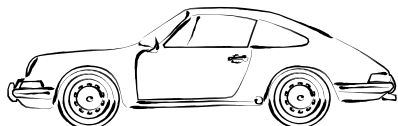

Body Parts

911 T/E/S

2.0-2.4 L, 1964-1973

Pre-impact bumper models, 2 inlet exhausts



591076 (1681000380) right
(OE 911.503.402.04)
Door panel
Painted galvanized steel



591075-1 (1681000570) left
(OE 901.501.145.23)
Rocker panel/wheel case support. To be welded
to the wheel house
Painted aluminized steel



591075-2 (1681000580) right
(OE 901.501.146.23)
Rocker panel/wheel case support. To be welded
to the wheel house
Painted aluminized steel



591077 (1682500270) left
(OE 911.501.123.03)
Inner rocker panel
Painted aluminized steel



591078 (1682500280) right
(OE 911.501.124.03)
Inner rocker panel
Painted aluminized steel



591079 (1681700300)
(OE 901.501.153.21)
Jack receiver socket
Painted galvanized steel



591080 (1681700400)
(OE 901.501.151.22)
Jack receiver socket
Painted aluminized steel



591083 (1682400170) left
(OE 911.501.965.00)
Inner rail piece
Painted aluminized steel



591084 (1682400180) right
(OE 911.501.966.00)
Inner rail piece
Painted aluminized steel

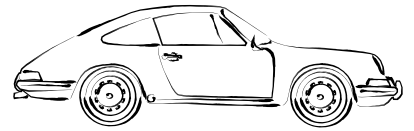

2.0-2.4 L, 1964-1973

Pre-impact bumper models, 2 inlet exhausts



591087 (1684400570) left
(OE 901.505.021.20)
Rear bumper corner
64-68 (short wheel base)
Painted spcc steel

591088 (1684400580) right
(OE 901.505.022.20)
Rear bumper corner
64-68 (short wheel base)
Painted spcc steel

591095 (1680600200)
(OE 901.505.023.20)
Rear center panel
Painted aluminized steel



591095ALU (1680600406)
(OE 901.505.023.20)
Rear center panel
Aluminium

591131 (1682700400)
(OE 911.501.177.02)
Fuel tank and battery support
70-73
Painted aluminized steel

591187 (1684400670) left
(OE 901.505.021.21)
Rear bumper corner
69-73 (long wheel base)
Painted spcc steel



591188 (1684400680) right
(OE 901.505.022.21)
Rear bumper corner
69-73 (long wheel base)
Painted spcc steel



Exhausts

911 /S/ CARRERA

2.7 L, 1974-1977

Impact bumper models, 2 inlet exhausts

N.B.: The products mentioned in this section can also be used for sport exhaust conversion for 3.0 L models



92.211 (1620607900)

(OE 911.111.025.01)

Rear exhaust, 2 in - 1 out, Ø60 mm tail pipe in polished stainless steel 304/4301

Box in painted aluminized steel

With TÜV/EEC approval



92.2110E (1620609100)

(OE 911.111.025.01)

Rear exhaust, 2 in - 1 out, Ø60 mm tail pipe in polished stainless steel 304/4301

OE specifications

Box in painted stainless steel 304/4301

With TÜV/EEC approval



92.211S (1620608400)

(OE 911.111.025.01)

Rear exhaust, 2 in - 1 out, Ø60 mm tail pipe

OE specifications

Polished stainless steel 304/4301

With TÜV/EEC approval



92.211USA (1620608000)

Rear exhaust, 2 in - 1 out, Ø60 mm tail pipe

With EGR connection for USA/Canada

Painted aluminized steel



92.511 (1620605400)

Rear exhaust, 2 in - 1 out, Ø70 mm tail pipe in

polished stainless steel 304/4301

Box in painted aluminized steel

With TÜV/EEC approval



92.511S (1620603500)

Rear exhaust, 2 in - 1 out, Ø70 mm tail pipe

Polished stainless steel 304/4301

With TÜV/EEC approval



92.510DUAL (1620605800)

Rear exhaust, 2 in - 2 out, Ø50 mm centre tail

pipes. 2 x 92.900S can be fitted as stainless

steel tail pipes (easy mount on type)

Painted aluminized steel



92.510DUALS (1620605700)

Rear exhaust, 2 in - 2 out, Ø50 mm centre tail

pipes. 2 x 92.900S can be fitted as stainless

steel tail pipes (easy mount on type)

Polished stainless steel



92.511SD (1620604100)

Rear exhaust, 2 in - 2 out, Ø70 mm tail pipe

Polished stainless steel 304/4301

With TÜV/EEC approval



Exhausts

911/S/CARRERA

2.7 L, 1974-1977

Impact bumper models, 2 inlet exhausts



N.B.: The products mentioned in this section can also be used for sport exhaust conversion for 3.0 L models



92.212 (1620607000)

Rear exhaust, no street use. 92.213 needed for fitting the exhaust on 91.019S and 91.020S. Ø 70 mm tail pipes
Painted steel

92.213 (1620401110)

Exhaust tubes to connect exhaust box 92.212 to racing heat exchangers 91.019S/91.020S
Painted steel



91.014 (1620800470) left

Exhaust racing tube without heating function, Ø 38 mm outside. Replacing heat exchanger 91.011
Painted chrome steel 409/4512



91.015 (1620800480) right

Exhaust racing tube without heating function, Ø 38 mm outside. Replacing heat exchanger 91.012
Painted chrome steel 409/4512



91.019S (1623101970) left

Exhaust racing heat exchanger without heating function, Ø45 mm outside. Fits 92.212 directly with use of exhaust tubes 92.213. 91.021S needed for use with standard exhausts
Stainless steel 304/4301



91.020S (1623101980) right

Exhaust racing heat exchanger without heating function, Ø45 mm outside. Fits 92.212 directly with use of exhaust tubes 92.213. 91.021S needed for use with standard exhausts
Stainless steel 304/4301



91.021S (1620400110)

Exhaust tube set, connecting racing heat exchangers 91.019S/91.020S to standard exhaust with 2 inlets
Stainless steel 304/4301



91.022S (1620101010)

Racing header set with pipes to connect to standard exhaust with 2 inlets. Ø45 mm outside
Stainless steel 304/4301



91.011 (1623102370)* left
(OE 911.211.021.60)

Heat exchanger
Painted aluminized steel

* Not for mechanical injection models





Exhausts

911/S/CARRERA

2.7 L, 1974-1977

Impact bumper models, 2 inlet exhausts



91.012 (1623102380) right
(OE 911.211.022.10)
Heat exchanger
Painted aluminized steel



91.011S (1623102570)* left
(OE 911.211.021.60)
Heat exchanger
Polished stainless steel 304/4301



91.012S (1623102580) right
(OE 911.211.022.10)
Heat exchanger
Polished stainless steel 304/4301

* Not for mechanical injection models



91.013 (1623102670)* left
(OE 911.211.021.14)
Heat exchanger
Painted aluminized steel



91.013S (1623102770)* left
(OE 911.211.021.14)
Heat exchanger
Polished stainless steel 304/4301



90.001 (1623200270) left
(OE 901.211.007.22)
Heat control box
Painted aluminized steel

* For mechanical injection models

* For mechanical injection models



90.002 (1623200280) right
(OE 901.211.008.22)
Heat control box
Painted aluminized steel



911/S/CARRERA



2.7 L, 1974-1977

Impact bumper models, 2 inlet exhausts

N.B.: The products mentioned in this section can also be used for sport exhaust conversion for 3.0 L models

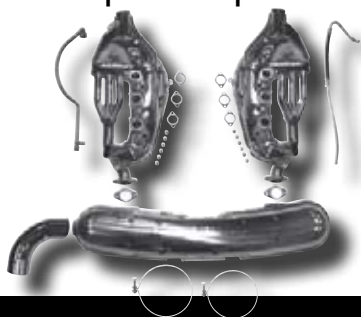

92.289S (1620000310)

Free-flow exhaust conversion set with single loose 84 mm tail pipe, Polished stainless steel. Contains:
1x92.512SL, 1x91.011S, 1x91.012S,
1x911.107.729.10, 1x911.107.739.10,
1x930.111.159.00, 1x930.111.175.00,
1x901.111.191.09, 6x930.111.191.09 and
12x999.085.001.02



92.289SD (1620000110)

Free-flow exhaust conversion set with double loose 84 mm tail pipes, Polished stainless steel. Contains:
1x92.512SDL, 1x91.011S, 1x91.012S,
1x911.107.729.10, 1x911.107.739.10,
1x930.111.159.00, 1x930.111.175.00,
1x901.111.193.00, 6x930.111.191.09 and
12x999.085.001.02



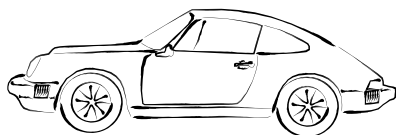

Mounting Kits & Tail Pipes

911/S/CARRERA

2.7 L, 1974-1977

Impact bumper models, 2 inlet exhausts



91.011KIT (1621701410)
Mounting kit for heat exchanger
Fits 91.011, 91.011S, 91.012, 91.012S,
91.013 and 91.013S



92.255S (1620650200)
Exhaust adaptor. To be used when installing 3.6
964/993 engine into G-model cars and still
using "banana" style exhaust boxes!



92.900S (1620704800)
(OE 901.111.245.01)
Tail pipe, 50.5 x 170 x 60 mm
Stainless steel 304/4301



901.111.245.01 (1620700500)
(OE 901.111.245.01)
Exhaust tip, push on type
Chromed stainless steel 304/4301



911.111.245.00 (1620700400)
(OE 911.111.245.00)
Exhaust tip, push on type
Black painted steel



2.7 L, 1974-1977

Impact bumper models, 2 inlet exhausts

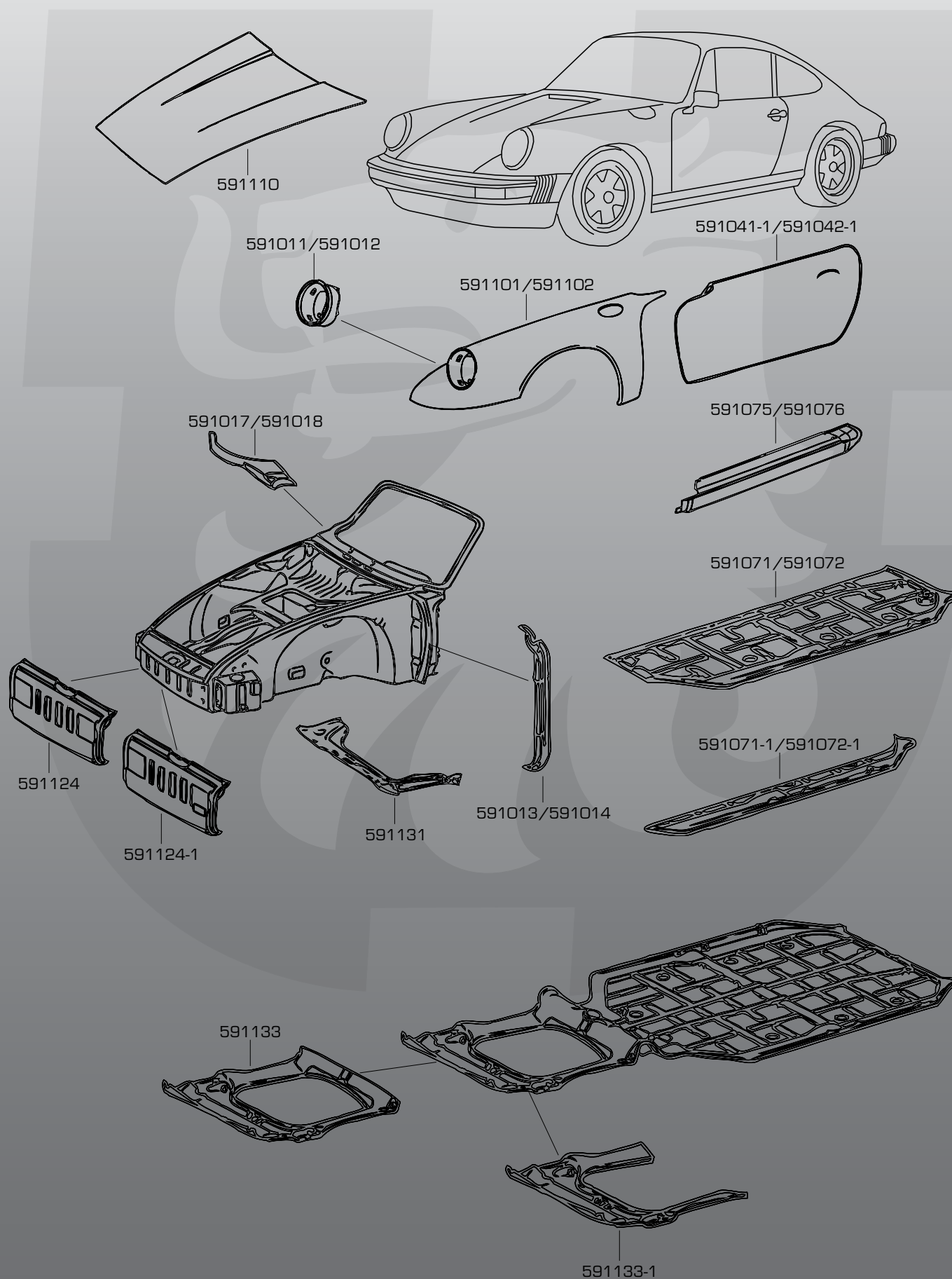

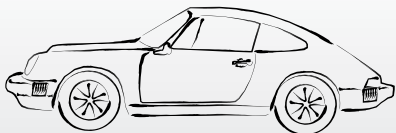

Body Parts

911/911S

2.7 L, 1974-1977

Impact bumper models, 2 inlet exhausts

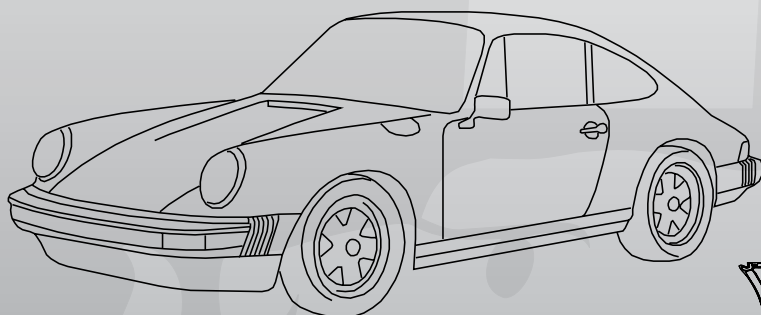

591096

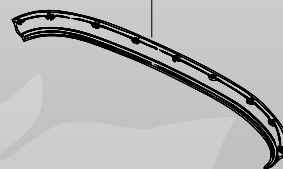

591085/591086
591185/591186



591047/591048



591149/591150

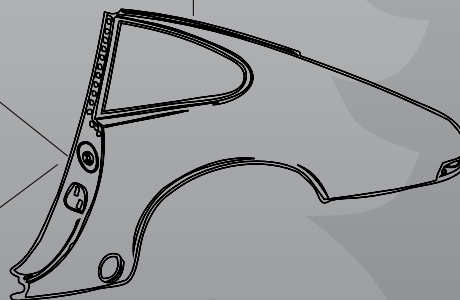

591151/591152

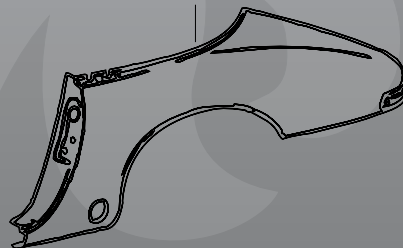

591047-1/591048-1



591179



591077/591078

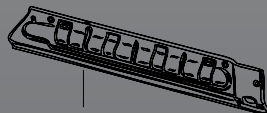

591080



591075-1/591075-2

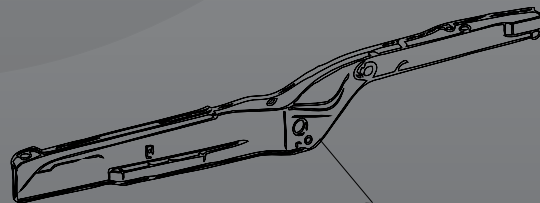
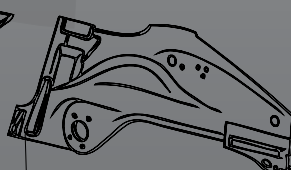

591083/591084



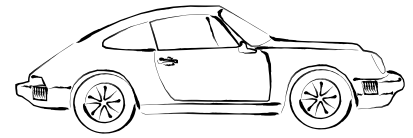

93020101002 (1615600200)
(OE 930.201.010.02)
Fuel tank (without inside baffle), 85 L
Painted steel



591011 (1682000270) left
(OE 911.503.015.00)
Headlight bucket
Painted spcc steel



591012 (1682000280) right
(OE 911.503.016.00)
Headlight bucket
Painted spcc steel



591013 (1682300270) left
(OE 911.501.053.00)
Fender joining plate
Painted aluminized steel



591014 (1682300280) right
(OE 911.501.054.00)
Fender joining plate
Painted aluminized steel



591017 (1684000170) left
(OE DAN.503.087.42)
Repair piece for windshield frame
Painted aluminized steel



591018 (1684000180) right
(OE DAN.503.088.42)
Repair piece for windshield frame
Painted aluminized steel



591041-1 (1680900270) left
(OE DAN.531.005.22)
Complete door skin
Painted galvanized steel



591042-1 (1680900280) right
(OE DAN.531.006.22)
Complete door skin
Painted galvanized steel

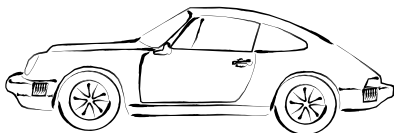

Body Parts

911 /S/CARRERA

2.7 L, 1974-1977

Impact bumper models, 2 inlet exhausts



591047 (1681900170) left
(OE 911.502.041.04)
Door jamb
Painted aluminized steel



591048 (1681900180) right
(OE 911.502.042.04)
Door jamb
Painted aluminized steel



591047-1 (1681900270) left
(OE 964.502.041.00)
Door jamb, complete with quarter window frame
part
Painted spcc steel



591048-1 (1681900280) right
(OE 964.502.042.00)
Door jamb, complete with quarter window frame
part
Painted spcc steel



591071 (1683100170) left
(OE 911.501.935.00)
Complete floor
Painted aluminized steel



591072 (1683100180) right
(OE 911.501.936.00)
Complete floor
Painted aluminized steel



591071-1 (1683100670) left
(OE DAN.501.935.00)
Floor pan outer repair section, 180 mm
Painted aluminized steel



591072-1 (1683100680) right
(OE DAN.501.936.00)
Floor pan outer repair section, 180 mm
Painted aluminized steel



591075 (1681000370) left
(OE 911.503.401.04)
Door panel
Painted galvanized steel

Body Parts

911/S/CARRERA

2.7 L, 1974-1977

Impact bumper models, 2 inlet exhausts

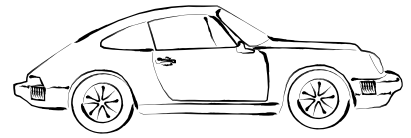

591076 (1681000380) right
(OE 911.503.402.04)
Door panel
Painted galvanized steel

591075-1 (1681000570) left
(OE 901.501.145.23)
Rocker panel/wheel case support. To be welded
to the wheel house
Painted aluminized steel

591075-2 (1681000580) right
(OE 901.501.146.23)
Rocker panel/wheel case support. To be welded
to the wheel house
Painted aluminized steel



591077 (1682500270) left
(OE 911.501.123.03)
Inner rocker panel
Painted aluminized steel

591078 (1682500280) right
(OE 911.501.124.03)
Inner rocker panel
Painted aluminized steel

591080 (1681700400)
(OE 901.501.151.22)
Jack receiver socket
Painted aluminized steel



591083 (1682400170) left
(OE 911.501.965.00)
Inner rail piece
Painted aluminized steel

591084 (1682400180) right
(OE 911.501.966.00)
Inner rail piece
Painted aluminized steel

591085 (1680600670) left
(OE 911.503.067.02)
Lower bumper corner, rear
Not Carrera
Painted spcc steel



Body Parts

911 /S/CARRERA

2.7 L, 1974-1977

Impact bumper models, 2 inlet exhausts



591086 (1680600680) right
(OE 911.503.068.02)
Lower bumper corner, rear
Not Carrera
Painted spcc steel



591096 (1680600300)
(OE 911.505.171.08)
Lower rear panel
Painted aluminized steel



591101 (1680300270) left
(OE 911.503.031.10)
Front fender
Painted spcc steel



591102 (1680300280) right
(OE 911.503.032.10)
Front fender
Painted spcc steel



591110 (1680100200)
(OE 911.511.010.01)
Bonnet
Painted spcc steel



591124 (1680500300)
(OE 911.501.099.04)
Partition wall
Painted aluminized steel



591124-1 (1680500500)
(OE 911.501.099.07)
Partition wall with hole for air condition
Painted aluminized steel



591131 (1682700400)
(OE 911.501.177.02)
Fuel tank and battery support
Painted aluminized steel



591133 (1683100200)
(OE 911.501.955.00)
Front floor with suspension mounts
Painted aluminized steel

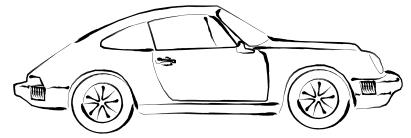

591133-1 (1683100700)
(OE 911.501.955.01)
Front suspension repair panel
Painted aluminized steel



591149 (1680400570) left
(OE 911.503.061.04)
Quarter panel
Coupé
Painted spcc steel



591150 (1680400580) right
(OE 911.503.062.04)
Quarter panel
Coupé
Painted spcc steel



591151 (1680400670) left
(OE 911.503.061.44)
Quarter panel
Targa
Painted spcc steel



591152 (1680400680) right
(OE 911.503.062.44)
Quarter panel
Targa
Painted spcc steel



591179 (1681700500)
(OE 911.501.195.00)
Jack receiver socket
Painted aluminized steel



591185 (1680600770) left
(OE 911.503.067.03)
Lower bumper corner, rear
Carrera
Painted aluminized steel



591186 (1680600780) right
(OE 911.503.068.03)
Lower bumper corner, rear
Carrera
Painted aluminized steel



Exhausts

911 SC/CARRERA

2.7-3.2 L, 1978-1989

Impact bumper models, 1 inlet exhausts



92.201 (1620609400)
(OE 930.111.043.00)

Rear exhaust, Ø60 mm tail pipe in polished stainless steel 304/4301
Box in painted aluminized steel
With TÜV/EEC approval



92.1010E (1620608700)
(OE 930.111.022.00)

Rear exhaust, Ø60 mm tail pipe. OE specifications
For 2.7 and 3.0 L models
Painted stainless steel 304/4301
With TÜV/EEC approval



92.2010E (1620607400)
(OE 930.111.043.00)

Rear exhaust, Ø60 mm tail pipe in polished stainless steel 304/4301. OE specifications
For 3.2 L models
Box in painted aluminized steel
With TÜV/EEC approval



92.201S (1620609600)
(OE 930.111.043.00)

Rear exhaust, Ø60 mm tail pipe
Polished stainless steel 304/4301
With TÜV/EEC approval



92.501 (1620606300)

Rear sport exhaust, Ø70 mm tail pipe in polished stainless steel 304/4301
Box in painted aluminized steel
With TÜV/EEC approval



92.502S (1620606400)
(OE 930.111.043.00)

Rear sport exhaust, Ø84 mm tail pipe
Polished stainless steel 304/4301
With TÜV/EEC approval



92.502SL (1620606500)
(OE 930.111.043.00)

Rear sport exhaust, Ø84 mm loose tail pipe (weld on type)
Polished stainless steel 304/4301
With TÜV/EEC approval



92.502SD (1620604400)
(OE 930.111.043.00)

Rear sport exhaust, double Ø84 mm tail pipes
Polished stainless steel 304/4301
With TÜV/EEC approval



92.502SDL (1620604500)
(OE 930.111.043.00)

Rear sport exhaust, double Ø84 mm loose tail pipes (weld on type)
Polished stainless steel 304/4301
With TÜV/EEC approval



911SC/CARRERA

2.7-3.2 L, 1978-1989

Impact bumper models, 1 inlet exhausts

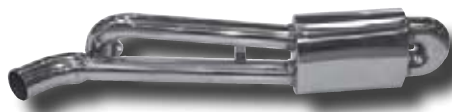

92.601S (1620609300)

Rear sport exhaust, 1 in - 1 out, Ø75 mm tail pipe

For 3.2 L model (using standard gaskets)

Polished stainless steel 304/4301

Economy model without TÜV/EEC approval

92.602S (1620609200)

Rear sport exhaust, 1 in - 1 out, Ø75 mm tail pipe

For 2.7-3.0 L models (using standard gaskets)

Polished stainless steel 304/4301

Economy model without TÜV/EEC approval

PO-92100S (1620301300)

(OE 930.113.230.25)

Sport catalytic converter with Lambda sensor hole, 100 cells

Polished stainless steel 304/4301



92.100 (1620500200)

(OE 930.111.183.01)

Pre-silencer

Painted steel

With TÜV/EEC approval

92.100S (1620500300)

(OE 930.111.183.01)

Pre-silencer

Polished stainless steel 304/4301

With TÜV/EEC approval

92.300 (1620200500)

(OE 930.111.183.00)

Sport pre-silencer bypass without baffling with Lambda sensor hole

Painted steel



92.300S (1620200600)

(OE 930.111.183.00)

Sport pre-silencer bypass without baffling with Lambda sensor hole

Polished stainless steel 304/4301

92.102 (1620400200)

(OE 930.111.157.01)

Connector for cross over pipe

For 2.7 and 3.0 L models

Painted steel

92.102S (1620400400)

(OE 930.111.157.01)

Connector for cross over pipe

For 2.7 and 3.0 L models

Polished stainless steel 304/4301





Exhausts

911 SC/CARRERA

2.7-3.2 L, 1978-1989

Impact bumper models, 1 inlet exhausts



92.103 (1620400900)
(OE 930.111.163.02)
Cross over pipe
For 2.7 and 3.0 L models
Painted steel



92.103S (1620401000)
(OE 930.111.163.02)
Cross over pipe
For 2.7 and 3.0 L models
Polished stainless steel 304/4301



92.104S (1620400800)
(OE 930.111.169.05)
One piece cross over pipe
For 3.2 L models
Polished stainless steel 304/4301

Dansk
ORIGINAL

Dansk
ORIGINAL

Dansk
ORIGINAL



91.101 (1623103300) left/right
(OE 930.211.025.01)
Heat exchanger
For 2.7 and 3.0 L models
Painted steel



91.101G (1623102100) left/right
(OE 930.211.025.01)
Heat exchanger
For 2.7 and 3.0 L models
Galvanized steel



91.101S (1623103500) left/right
(OE 930.211.025.01)
Heat exchanger
For 2.7 and 3.0 L models
Polished stainless steel 304/4301

Dansk
ORIGINAL

Dansk
ORIGINAL

Dansk
ORIGINAL



91.104 (1623103900) left/right
(OE 930.211.029.01)
Heat exchanger
For 3.2 L models
Painted steel



91.104S (1623104000) left/right
(OE 930.211.029.01)
Heat exchanger
For 3.2 L models
Polished stainless steel 304/4301



91.019S (1623101970) left
Exhaust racing heat exchanger without heating
function, Ø45 mm outside
Stainless steel 304/4301

Dansk
ORIGINAL

Dansk
ORIGINAL

Dansk
MOTORSPORT

911SC/CARRERA

2.7-3.2 L, 1978-1989

Impact bumper models, 1 inlet exhausts



91.020S (1623101980) right
Exhaust racing heat exchanger without heating function, Ø45 mm outside
Stainless steel 304/4301



91.021S (1620400110)
Exhaust tube set, connecting racing heat exchangers 91.019S/91.020S to standard exhaust with 2 inlets
Stainless steel 304/4301

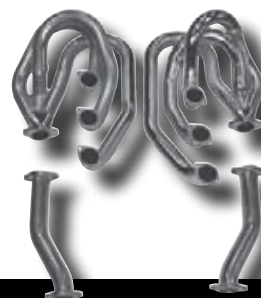

91.022S (1620101010)
Racing header set with pipes to connect to standard exhaust with 2 inlets. Ø45 mm outside
Stainless steel 304/4301



90.001 (1623200270) left
(OE 901.211.007.22)
Heat control box, short version
Painted aluminized steel



90.002 (1623200280) right
(OE 901.211.008.22)
Heat control box, short version
Painted aluminized steel



90.005 (1623200170) left
(OE 911.211.013.01)
Heat control box, long version
Painted aluminized steel



90.006 (1623200180) right
(OE 911.211.014.01)
Heat control box, long version
Painted aluminized steel





Exhausts

911 SC/CARRERA

2.7-3.2 L, 1978-1989

Impact bumper models, 1 inlet exhausts



92.289S (1620000310)

Free-flow exhaust conversion set with single loose 84 mm tail pipe, Polished stainless steel. 2.7-3.0 eng.
Contains: 1x92.512SL, 1x91.011S, 1x91.012S, 1x911.107.729.10, 1x911.107.739.10, 1x930.111.159.00, 1x930.111.175.00, 2x901.111.193.00, 6x930.111.191.09 and 12x999.085.001.02



92.289SD (1620000110)

Free-flow exhaust conversion set with double loose 84 mm tail pipes, Polished stainless steel. 2.7-3.0 eng.
Contains: 1x92.512SDL, 1x91.011S, 1x91.012S, 1x911.107.729.10, 1x911.107.739.10, 1x930.111.159.00, 1x930.111.175.00, 2x901.111.193.00, 6x930.111.191.09 and 12x999.085.001.02



Mounting Kits & Tail Pipes

911SC/CARRERA

2.7-3.2 L, 1978-1989

Impact bumper models, 1 inlet exhausts

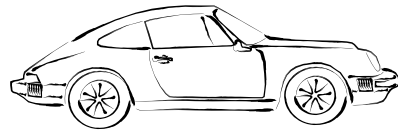

91.101KIT (1621701510)
Mounting kit for heat exchanger
Fits 91.101, 91.101G and 91.101S

91.104KIT (1621701710)
Mounting kit for heat exchanger
Fits 91.104 and 91.104S

92.100KIT (1621700310)
Mounting kit for pre-silencer
Fits 92.100, 92.100S, PO-92100S, 92.300
and 92.300S



92.201KIT (1621700210)
Mounting kit for rear exhaust
Fits 92.201, 92.2010E, 92.201S, 92.501,
92.502S, 92.502SL, 92.502SD and
92.502SDL

92.250S (1620700670) left
Loose tail pipe, Ø84 mm (weld on type)
Polished stainless steel 304/4301

92.251S (1620700680) right
Loose tail pipe, Ø84 mm (weld on type)
Polished stainless steel 304/4301



93.900S (1620704700)
(OE 993.111.145.99)
Tail pipe, universal (weld on type)
Polished stainless steel 304/4301

901.111.245.01 (1620700500)
(OE 901.111.245.01)
Exhaust tip, push on type
Chromed stainless steel 304/4301

911.111.245.00 (1620700400)
(OE 911.111.245.00)
Exhaust tip, push on type
Black painted steel

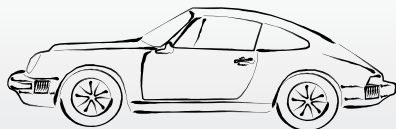

Body Parts

911 SC/CARRERA

2.7-3.2 L, 1978-1989

Impact bumper models, 1 inlet exhaust

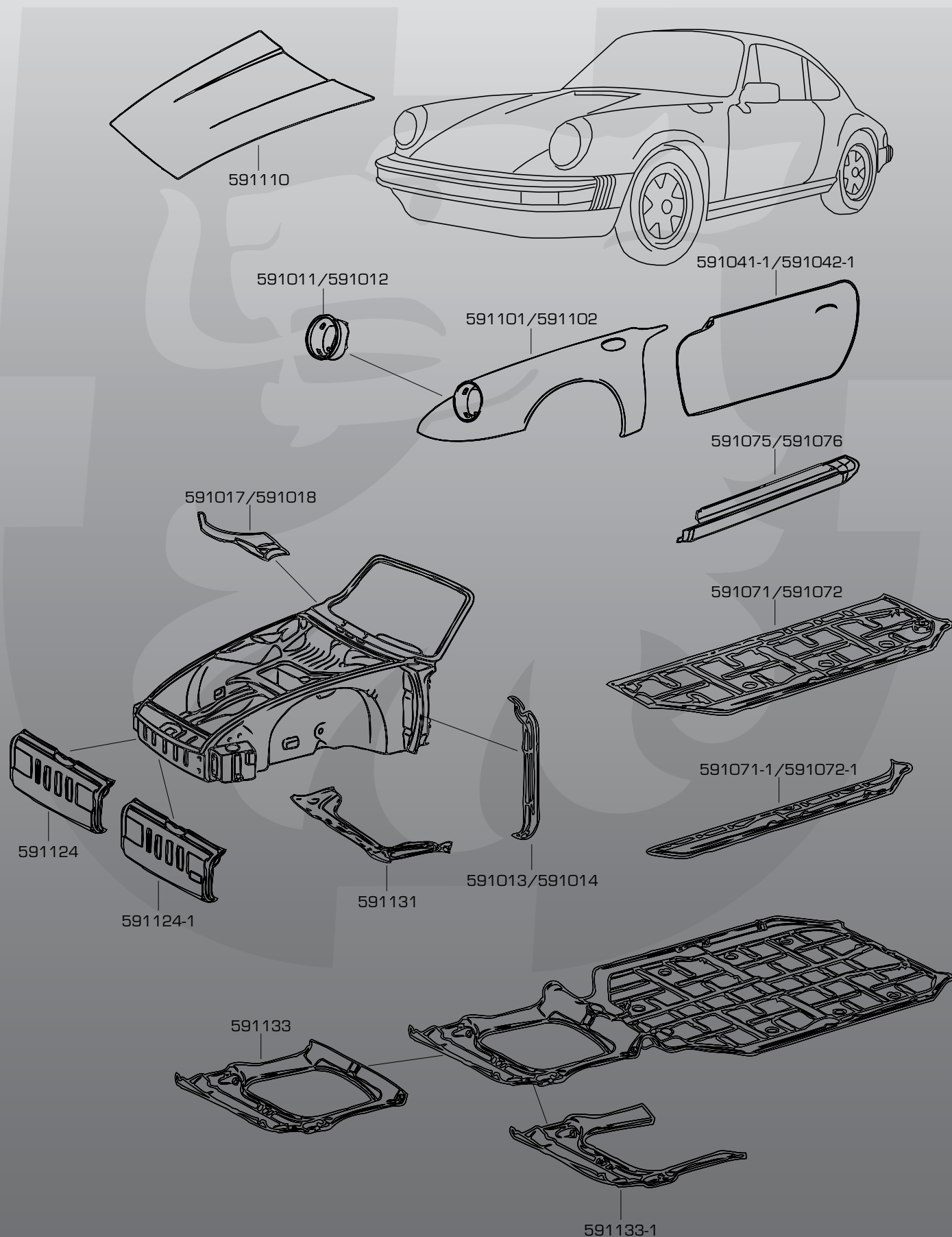

911 SC/CARRERA

2.7-3.2 L, 1978-1989

Impact bumper models, 1 inlet exhaust

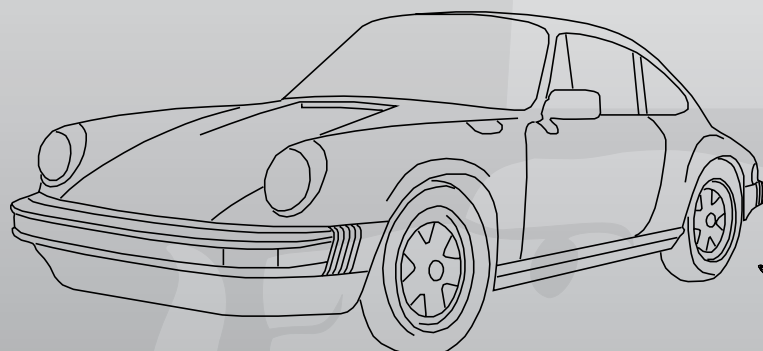

591096

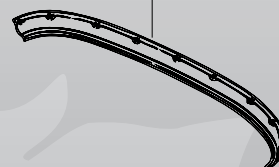

591085/591086
591185/591186



591047/591048



591149/591150

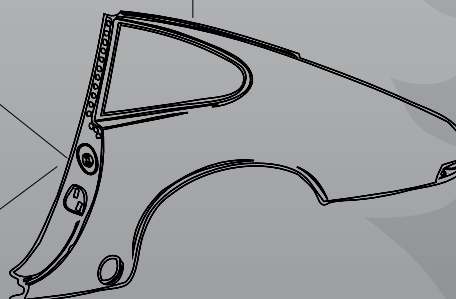

591151/591152

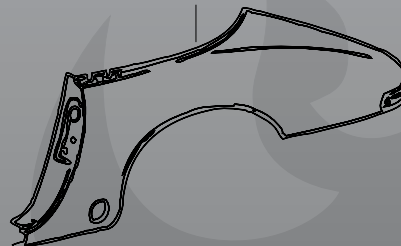

591047-1/591048-1



591179



591077/591078



591080



591181/591182



591075-1/591075-2

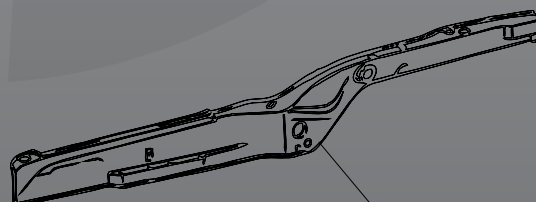

591083/591084





Body Parts

911 SC/CARRERA

2.7-3.2 L, 1978-1989

Impact bumper models, 1 inlet exhausts



93020101002 (1615600200)
(OE 930.201.010.02)
Fuel tank (without inside baffle), 85 L
Painted steel



591011 (1682000270) left
(OE 911.503.015.00)
Headlight bucket
76-86
Painted spcc steel



591012 (1682000280) right
(OE 911.503.016.00)
Headlight bucket
76-86
Painted spcc steel



591013 (1682300270) left
(OE 911.501.053.00)
Fender joining plate
Painted aluminized steel



591014 (1682300280) right
(OE 911.501.054.00)
Fender joining plate
Painted aluminized steel



591017 (1684000170) left
(OE DAN.503.087.42)
Repair piece for windshield frame
Painted aluminized steel



591018 (1684000180) right
(OE DAN.503.088.42)
Repair piece for windshield frame
Painted aluminized steel



591041-1 (1680900270) left
(OE DAN.531.005.22)
Complete door skin
Painted galvanized steel



591042-1 (1680900280) right
(OE DAN.531.006.22)
Complete door skin
Painted galvanized steel

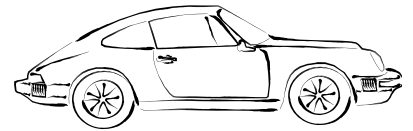

591047 (1681900170) left
(OE 911.502.041.04)
Door jamb
Painted aluminized steel



591048 (1681900180) right
(OE 911.502.042.04)
Door jamb
Painted aluminized steel



591047-1 (1681900270) left
(OE 964.502.041.00)
Door jamb, complete with quarter window frame
part
Painted aluminized steel



591048-1 (1681900280) right
(OE 964.502.042.00)
Door jamb, complete with quarter window frame
part
Painted aluminized steel



591071 (1683100170) left
(OE 911.501.935.00)
Complete floor
Painted aluminized steel



591072 (1683100180) right
(OE 911.501.936.00)
Complete floor
Painted aluminized steel



591071-1 (1683100670) left
(OE DAN.501.935.00)
Floor pan outer repair section, 180 mm
Painted aluminized steel



591072-1 (1683100680) right
(OE DAN.501.936.00)
Floor pan outer repair section, 180 mm
Painted aluminized steel



591075 (1681000370) left
(OE 911.503.401.04)
Door panel
Painted galvanized steel



Body Parts

911 SC/CARRERA

2.7-3.2 L, 1978-1989

Impact bumper models, 1 inlet exhausts



591076 (1681000380) right
(OE 911.503.402.04)
Door panel
Painted galvanized steel



591075-1 (1681000570) left
(OE 901.501.145.23)
Rocker panel/wheel case support. To be welded
to the wheel house
Painted aluminized steel



591075-2 (1681000580) right
(OE 901.501.146.23)
Rocker panel/wheel case support. To be welded
to the wheel house
Painted aluminized steel



591077 (1682500270) left
(OE 911.501.123.03)
Inner rocker panel
Painted aluminized steel



591078 (1682500280) right
(OE 911.501.124.03)
Inner rocker panel
Painted aluminized steel



591080 (1681700400)
(OE 901.501.151.22)
Jack receiver socket
78-84
Painted aluminized steel



591083 (1682400170) left
(OE 911.501.965.00)
Inner rail piece
Painted aluminized steel



591084 (1682400180) right
(OE 911.501.966.00)
Inner rail piece
Painted aluminized steel



591096 (1680600300)
(OE 911.505.171.08)
Lower rear panel
Painted aluminized steel

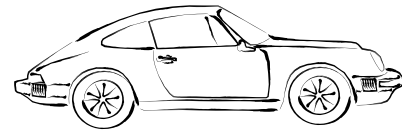

591101 (1680300270) left
(OE 911.503.031.10)
Front fender
Painted spcc steel

591102 (1680300280) right
(OE 911.503.032.10)
Front fender
Painted spcc steel

591110 (1680100200)
(OE 911.511.010.01)
Bonnet
Painted spcc steel



591124 (1680500300)
(OE 911.501.099.04)
Partition wall
76-82
Painted aluminized steel

591124-1 (1680500500)
(OE 911.501.099.07)
Partition wall with hole for air condition
76-82
Painted aluminized steel

591131 (1682700400)
(OE 911.501.177.02)
Fuel tank and battery support
Painted aluminized steel



591133 (1683100200)
(OE 911.501.955.00)
Front floor with suspension mounts
Painted aluminized steel

591133-1 (1683100700)
(OE 911.501.955.01)
Front suspension repair panel
Painted aluminized steel

591149 (1680400570) left
(OE 911.503.061.04)
Quarter panel
For 2.7 L Coupé models (narrow chassis),
74-77
Painted spcc steel



Body Parts

911 SC/CARRERA

2.7-3.2 L, 1978-1989

Impact bumper models, 1 inlet exhausts



591150 (1680400580) right
(OE 911.503.062.04)
Quarter panel
For 2.7 L Coupé models (narrow chassis),
74-77
Painted spcc steel



591151 (1680400670) left
(OE 911.503.061.44)
Quarter panel
For 2.7 L Targa models (narrow chassis),
74-77
Painted spcc steel



591152 (1680400680) right
(OE 911.503.062.44)
Quarter panel
For 2.7 L Targa models (narrow chassis),
74-77
Painted spcc steel



591179 (1681700500)
(OE 911.501.195.00)
Jack receiver socket
Painted aluminized steel



591181 (1681700670) left
(OE 911.507.077.40)
Gusset plate with floor jack support
Targa/Cabrio
85-89
Painted aluminized steel



591182 (1681700680) right
(OE 911.507.078.40)
Gusset plate with floor jack support
Targa/Cabrio
85-89
Painted aluminized steel



591085 (1680600670) left
(OE 911.503.067.02)
Lower bumper corner, rear
For 2.7 L models (narrow chassis), 74-77
Painted spcc steel



591086 (1680600680) right
(OE 911.503.068.02)
Lower bumper corner, rear
For 2.7 L models (narrow chassis), 74-77
Painted spcc steel



591185 (1680600770) left
(OE 911.503.067.03)
Lower bumper corner, rear
For Carrera/SC models (wide chassis)
Painted aluminized steel

Body Parts

911 SC/CARRERA

2.7-3.2 L, 1978-1989

Impact bumper models, 1 inlet exhausts



591186 (1680600780) right
(OE 911.503.068.03)
Lower bumper corner, rear
For Carrera/SC models (wide chassis)
Painted aluminized steel

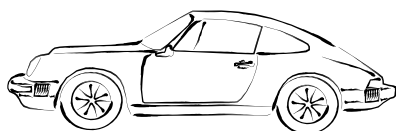

Exhausts

911 CONVERSION

Conversion for 3.2 L models,
2 inlet exhausts



92.512S (1620604900)
(OE 930.111.043.00)
Rear sport exhaust, 2 in - 1 out, Ø84 mm tail
pipe
Polished stainless steel 304/4301



92.512SD (1620605000)
(OE 930.111.043.00)
Rear sport exhaust, 2 in - 2 out, Ø84 mm tail
pipes
Polished stainless steel 304/4301



92.512SL (1620603700)
(OE 930.111.043.00)
Rear sport exhaust, 2 in - 1 out, Ø84 mm loose
tail pipe (weld on type)
Polished stainless steel 304/4301



92.512SDL (1620604300)
(OE 930.111.043.00)
Rear sport exhaust, 2 in - 2 out, double Ø84 mm
loose tail pipes (weld on type)
Polished stainless steel 304/4301



92.255S (1620650200)
Exhaust adaptor. To be used when installing 3.6
964/993 engine into G-model cars and still
using "banana" style exhaust boxes!



91.017S (1623103170) left
Sport heat exchanger with Lambda hole
Polished stainless steel 304/4301



91.018S (1623103180) right
Sport heat exchanger with Lambda hole
Polished stainless steel 304/4301

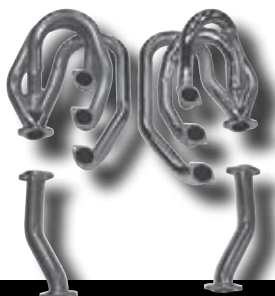

91.022S (1620101010)
Racing header set with pipes to connect to stan-
dard exhaust with 2 inlets. Ø45 mm outside
Stainless steel 304/4301



92.290S (1620000510)
Free-flow exhaust conversion set with single loose 84 mm
tail pipe, Polished stainless steel. Contains:
1x92.512SL, 1x91.017S, 1x91.018S,
1x911.107.729.10, 1x911.107.739.10,
1x930.111.159.00, 1x930.111.175.00,
2x901.111.193.00, 6x930.111.191.12 and
12x999.085.001.02



911 CONVERSION



Conversion for 3.2 L models 2 inlet exhausts



92.290SD (1620000210)

Free-flow exhaust conversion set with double loose 84 mm tail pipes, Polished stainless steel. Contains:
1x92.512SDL, 1x91.017S, 1x91.018S,
1x911.107.729.10, 1x911.107.739.10,
1x930.111.159.00, 1x930.111.175.00,
2x901.111.193.00, 6x930.111.191.12 and
12x999.085.001.02



90.001 (1623200270) left
(OE 901.211.007.22)

Heat control box (not suitable for models with
electrical heat control)
Painted aluminized steel



90.002 (1623200280) right
(OE 901.211.008.22)

Heat control box (not suitable for models with
electrical heat control)
Painted aluminized steel



90.005 (1623200170) left
(OE 911.211.013.01)

Heat control box, long version (suitable for mo-
dels with electrical heat control)
Painted aluminized steel



90.006 (1623200180) right
(OE 911.211.014.01)

Heat control box, long version (suitable for mo-
dels with electrical heat control)
Painted aluminized steel



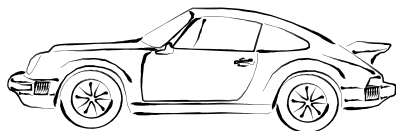

Exhausts

911/930 TURBO

3.0-3.3 L Turbo, 1975-1989



92.202S (1620608800)
(OE 930.111.025.04)
Rear exhaust with single tail pipe
Stainless steel 304/4301
75-77 models



92.204S (1620608200)
(OE 930.111.037.04)
Rear exhaust
Stainless steel 304/4301
78-83 models with wastegate pipe



92.203S (1620608900)
(OE 930.111.038.06)
Rear exhaust
Stainless steel 304/4301
84-89 models without wastegate pipe



92.208S (1620605500)
Rear exhaust with 1 tail pipe
Polished stainless steel 304/4301
84-89 models without wastegate pipe



92.208SD (1620605600)
Rear exhaust with 2 tail pipes
Polished stainless steel 304/4301
84-89 models without wastegate pipe



91.103 (1623103600) left/right
(OE 930.211.021.03)
Heat exchanger
Painted steel
75-83 models



91.103S (1623103800) left/right
(OE 930.211.021.03)
Heat exchanger
Polished stainless steel 304/4301
75-83 models



91.104 (1623103900) left/right
(OE 930.211.029.01)
Heat exchanger
Painted steel
84-89 models



91.104S (1623104000) left/right
(OE 930.211.029.01)
Heat exchanger
Polished stainless steel 304/4301
84-89 models



Exhausts

911/930 TURBO

3.0-3.3 L Turbo, 1975-1989



92.205S (1620200700)
(OE 930.111.003.04)
Turbo bypass pipe
Painted stainless steel 304/4301
75-89 models

92.205SS (1620200800)
(OE 930.111.003.04)
Turbo bypass pipe
Polished stainless steel 304/4301
75-89 models

92.102 (1620400200)
(OE 930.111.157.01)
Connector for cross over pipe
Painted steel



92.102S (1620400400)
(OE 930.111.157.01)
Connector for cross over pipe
Polished stainless steel 304/4301

92.103 (1620400900)
(OE 930.111.163.02)
Cross over pipe
Painted steel

92.103S (1620401000)
(OE 930.111.163.02)
Cross over pipe
Polished stainless steel 304/4301



90.001 (1623200270) left
(OE 901.211.007.22)
Heat control box, short version
Painted aluminized steel

90.002 (1623200280) right
(OE 901.211.008.22)
Heat control box, short version
Painted aluminized steel

90.005 (1623200170) left
(OE 911.211.013.01)
Heat control box, long version
Painted aluminized steel





Exhausts

911/930 TURBO

3.0-3.3 L Turbo, 1975-1989



90.006 (1623200180) right
(OE 911.211.014.01)
Heat control box, long version
Painted aluminized steel



92.209S (1620650100)
Wastegate connection pipe
Stainless steel 304/4301
75-83 models



Mounting Kits & Tail Pipes

911/930 TURBO

3.0-3.3 L Turbo, 1975-1989



91.103KIT (1621701610)
Mounting kit for heat exchanger
Fits 91.103 and 91.103S

91.104KIT (1621701710)
Mounting kit for heat exchanger
Fits 91.104 and 91.104S

92.203STAIL (1620704600)
Tail pipe, 3 pieces. Welding job must be done!
Stainless steel 304/4301
78-89 models



3.0-3.3 L Turbo, 1975-1989



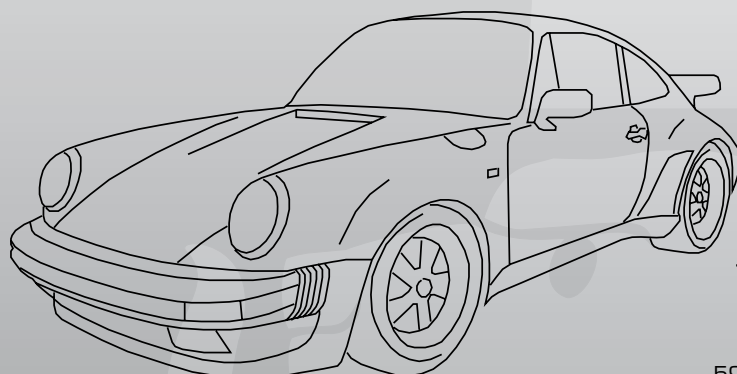

591096

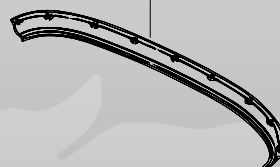

591385/591386

591047/591048



591047-1/591048-1

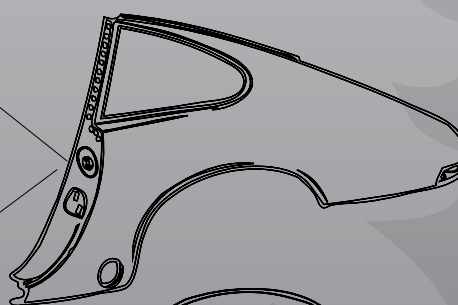

591383/591384

591179

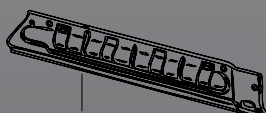

591077/591078



591080



591075-1/591075-2

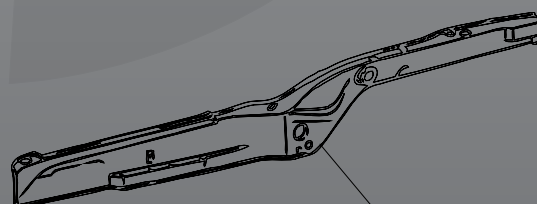
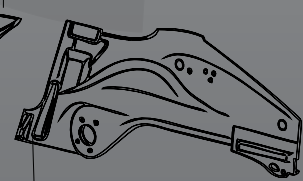

591083/591084



Body Parts

911/930 TURBO

3.0-3.3 L Turbo, 1975-1989



93020101002 (1615600200)
(OE 930.201.010.02)
Fuel tank (without inside baffle), 85 L
Painted steel



591011 (1682000270) left
(OE 911.503.015.00)
Headlight bucket
75-86
Painted spcc steel



591012 (1682000280) right
(OE 911.503.016.00)
Headlight bucket
75-86
Painted spcc steel



591013 (1682300270) left
(OE 911.501.053.00)
Fender joining plate
Painted aluminized steel



591014 (1682300280) right
(OE 911.501.054.00)
Fender joining plate
Painted aluminized steel



591017 (1684000170) left
(OE DAN.503.087.42)
Repair piece for windshield frame
Painted aluminized steel



591018 (1684000180) right
(OE DAN.503.088.42)
Repair piece for windshield frame
Painted aluminized steel



591041-1 (1680900270) left
(OE DAN.531.005.22)
Complete door skin
Painted galvanized steel



591042-1 (1680900280) right
(OE DAN.531.006.22)
Complete door skin
Painted galvanized steel

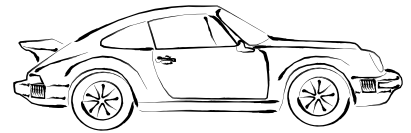

591047 (1681900170) left
(OE 911.502.041.04)
Door jamb
Painted aluminized steel



591048 (1681900180) right
(OE 911.502.042.04)
Door jamb
Painted aluminized steel



591047-1 (1681900270) left
(OE 964.502.041.00)
Door jamb, complete with quarter window frame
part
Painted aluminized steel



591048-1 (1681900280) right
(OE 964.502.042.00)
Door jamb, complete with quarter window frame
part
Painted aluminized steel



591071 (1683100170) left
(OE 911.501.935.00)
Complete floor
Painted aluminized steel



591072 (1683100180) right
(OE 911.501.936.00)
Complete floor
Painted aluminized steel



591071-1 (1683100670) left
(OE DAN.501.935.00)
Floor pan outer repair section, 180 mm
Painted aluminized steel



591072-1 (1683100680) right
(OE DAN.501.936.00)
Floor pan outer repair section, 180 mm
Painted aluminized steel



591075 (1681000370) left
(OE 911.503.401.04)
Door panel
Painted galvanized steel



Body Parts

911/930 TURBO

3.0-3.3 L Turbo, 1975-1989



591076 (1681000380) right
(OE 911.503.402.04)
Door panel
Painted galvanized steel



591075-1 (1681000570) left
(OE 901.501.145.23)
Rocker panel/wheel case support. To be welded
to the wheel house
Painted aluminized steel



591075-2 (1681000580) right
(OE 901.501.146.23)
Rocker panel/wheel case support. To be welded
to the wheel house
Painted aluminized steel



591077 (1682500270) left
(OE 911.501.123.03)
Inner rocker panel
Painted aluminized steel



591078 (1682500280) right
(OE 911.501.124.03)
Inner rocker panel
Painted aluminized steel



591080 (1681700400)
(OE 901.501.151.22)
Jack receiver socket
75-84
Painted aluminized steel



591083 (1682400170) left
(OE 911.501.965.00)
Inner rail piece
Painted aluminized steel



591084 (1682400180) right
(OE 911.501.966.00)
Inner rail piece
Painted aluminized steel



591096 (1680600300)
(OE 911.505.171.08)
Lower rear panel
Not Carrera
Painted aluminized steel

Body Parts

911/930 TURBO

3.0-3.3 L Turbo, 1975-1989

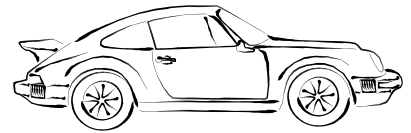

591110 (1680100200)
(OE 911.501.010.01)
Bonnet
Painted spcc steel



591124 (1680500300)
(OE 911.501.099.04)
Partition wall
75-82
Painted aluminized steel



591124-1 (1680500500)
(OE 911.501.099.07)
Partition wall with hole for air condition
75-82
Painted aluminized steel



591131 (1682700400)
(OE 911.501.177.02)
Fuel tank and battery support
Painted aluminized steel



591133 (1683100200)
(OE 911.501.955.00)
Front floor with suspension mounts
Painted aluminized steel



591133-1 (1683100700)
(OE 911.501.955.01)
Front suspension repair panel
Painted aluminized steel



591179 (1681700500)
(OE 911.501.195.00)
Jack receiver socket
Painted aluminized steel



591311 (1680300470) left
(OE 930.503.307.00)
Fender flare, front
Painted aluminized steel



591312 (1680300480) right
(OE 930.503.308.00)
Fender flare, front
Painted aluminized steel



Body Parts

911/930 TURBO

3.0-3.3 L Turbo, 1975-1989



591383 (1680400170) left
(OE 930.503.607.00)
Fender flare, rear
Painted aluminized steel



591384 (1680400180) right
(OE 930.503.608.00)
Fender flare, rear
Painted aluminized steel



591385 (1680600770) left
(OE 930.503.067.00)
Lower bumper corner, rear
Painted aluminized steel



591386 (1680600780) right
(OE 930.503.068.00)
Lower bumper corner, rear
Painted aluminized steel

Exhausts

911 C2/C4 (MODEL 964)

1990-1994

Not turbo



92.560S (1620606200)
(OE 964.111.045.04)

Rear centre exhaust for 2 tail pipes
Exhaust block-off is included if only right side tail pipe is used
Polished stainless steel 304/4301
With TÜV/EEC approval



92.561S (1620605910)
(OE 964.111.045.04)

Rear centre exhaust including oval tail pipes (model 92.247S)
Polished stainless steel 304/4301
With TÜV/EEC approval

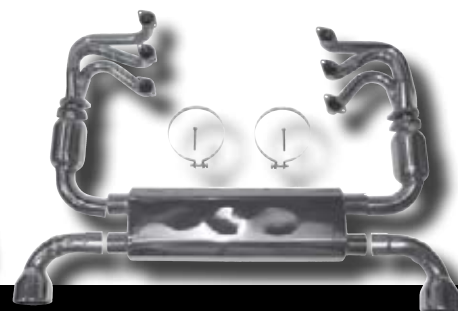

92.296S (1620801110)

Sport headers with catalytic converter (100 cells) and center exhaust system. Exhaust block-off is included if only right side tail pipe is used.
Polished stainless steel 304/4301



91.023S (1623104470) left
(OE 964.211.039.05)

Heat exchanger
Not for models with Tiptronic
Polished stainless steel 304/4301



91.024S (1623104480) right
(OE 964.211.040.04)

Heat exchanger
Polished stainless steel 304/4301



92.260S (1620801000)
(OE 964.111.042.05)

Sport catalytic converter without catalytic ceramic insert. With Lambda sensor hole and plug
Polished stainless steel 304/4301



PO-92260S (1620301400)
(OE 964.113.213.16)

Catalytic converter with catalytic ceramic insert, 100 cells. With Lambda sensor hole and plug
Polished stainless steel 304/4301



92.270S (1620607300)
(OE 964.111.046.05)

Rear exhaust, OE style and sound
Painted stainless steel 304/4301
With TÜV/EEC approval



92.280S (1620600900)
(OE 964.111.046.05)

Rear sport exhaust
Polished stainless steel 304/4301
With TÜV/EEC approval



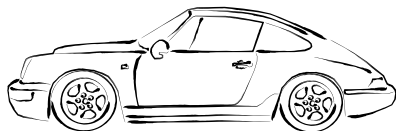

Exhausts

911 C2/C4 (MODEL 964)

1990-1994

Not turbo

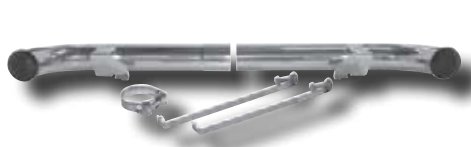

92.200S (1620700800)

(OE 641.111.044.00)

Sport bypass pipe. Replaces center exhaust box.
Supplied with clamp and stainless steel mounting
straps

Polished stainless steel 304/4301

92.220S (1620400700)

(OE RS4.111.044.00)

Bypass pipe, short. Replaces center exhaust box.
Polished stainless steel 304/4301

92.220SL (1620400600)

Bypass pipe, long. Replaces center exhaust box.
Polished stainless steel 304/4301



Mounting Kits & Tail Pipes

911 C2/C4 (MODEL 964)



1990-1994
Not turbo



92.240S (1620701000)
Tail pipe, Ø102 mm, angle cut end, clamp on type
Polished stainless steel 304/4301

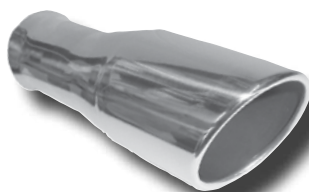

92.241S (1620701100)
Tail pipe, Ø102 mm, flared angle end, clamp on type
Polished stainless steel 304/4301



92.242S (1620701200)
Tail pipe, Ø102 mm, with baffle insert, angle cut end, clamp on type
Polished stainless steel 304/4301



92.245S (1620701910)
Tail pipe set for 92.560S, clamp on type
Polished stainless steel 304/4301



92.247S (1620702010)
Tail pipe set for 92.560S, 993 look, clamp on type
Polished stainless steel 304/4301

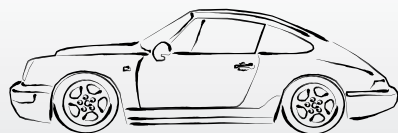

Body Parts

911 C2/C4 (MODEL 964)

1990-1994

Not turbo

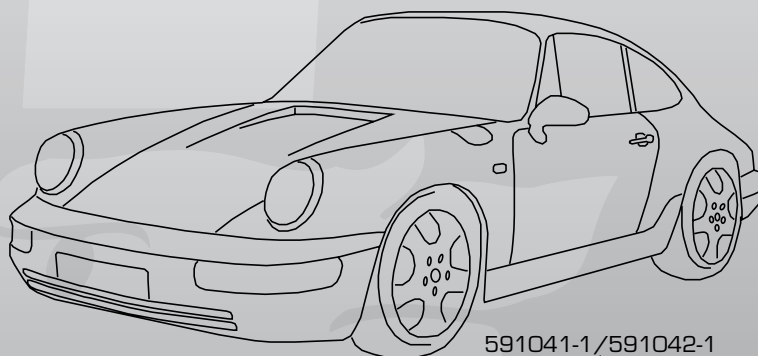

591041-1/591042-1

591201/591202

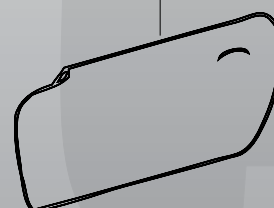
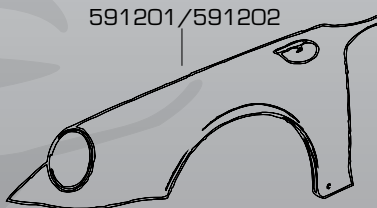

591073/591074

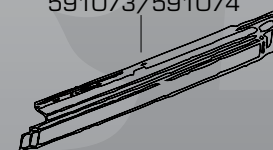

591075/591076



591091-2

591091-1

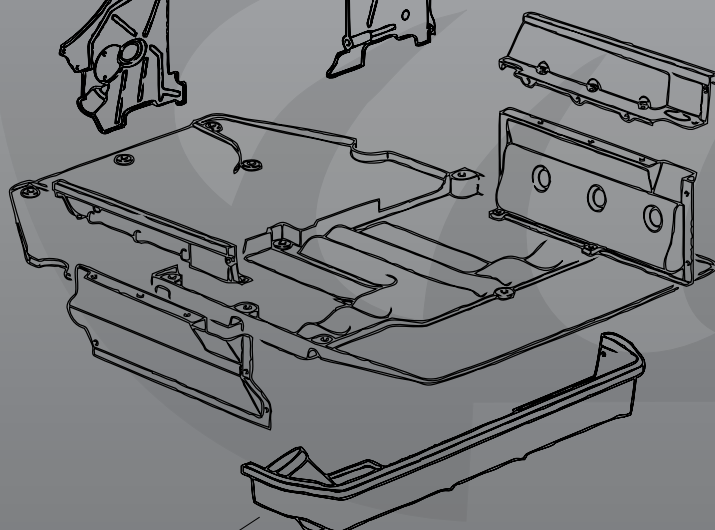
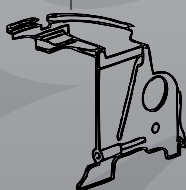
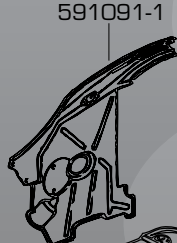

591094

Body Parts

911 C2/C4 (MODEL 964)

1990-1994
Not turbo

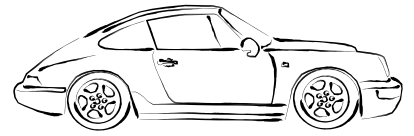

591041-1 (1680900270) left
(OE DAN.531.005.22)
Complete door skin
Painted galvanized steel

591042-1 (1680900280) right
(OE DAN.531.006.22)
Complete door skin
Painted galvanized steel

591073 (1681000270) left
(OE 965.503.401.01)
Outer door panel
Painted galvanized steel



591074 (1681000280) right
(OE 965.503.402.01)
Outer door panel
Painted galvanized steel

591075 (1681000370) left
(OE 911.503.401.04)
Door panel
Painted galvanized steel

591076 (1681000380) right
(OE 911.503.402.04)
Door panel
Painted galvanized steel



591091-1 (1682600270) left
(OE 964.106.283.08)
Engine cover
Painted aluminized steel

591091-2 (1682600280) right
(OE 964.106.283.09)
Engine cover
Painted aluminized steel

591094 (1682600100)
(OE 964.106.014.02)
Engine cover, rear
Painted aluminized steel

Under development

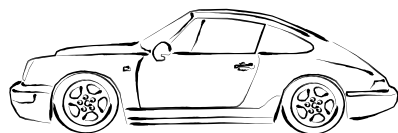

Body Parts

911 C2/C4 (MODEL 964)

1990-1994

Not turbo



591201 (1680300370) left

(OE 964.503.031.04)

Front fender

Painted spcc steel

591202 (1680300380) right

(OE 964.503.032.02)

Front fender

Painted spcc steel

Exhausts

911 TURBO (MODEL 965)

1990-1994

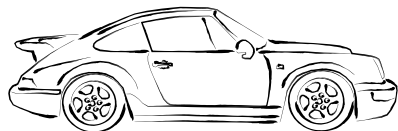

92.270S (1620607300)
(OE 964.111.046.05)
Rear exhaust, OE style and sound
Painted stainless steel 304/4301
With TÜV/EEC approval



92.280S (1620600900)
(OE 964.111.046.05)
Rear sport exhaust
Polished stainless steel 304/4301
With TÜV/EEC approval



92.220S (1620400700)
(OE RS4.111.044.00)
Bypass pipe, short. Replaces rear exhaust
Polished stainless steel 304/4301



92.205S (1620200700)
(OE 930.111.003.04)
Turbo bypass pipe
Painted stainless steel 304/4301



92.205SS (1620200800)
(OE 930.111.003.04)
Turbo bypass pipe
Polished stainless steel 304/4301



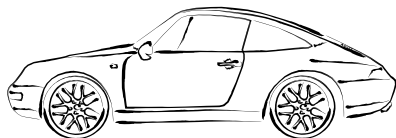

Exhausts

911 C2/C4 (MODEL 993)

3.6 L, 1994-1998

Not turbo



93.300S (1620601710)
(OE 993.111.993.00)
Rear sport exhaust set, 2 pcs.
Polished stainless steel 304/4301
With TÜV/EEC approval



93.300SEXP (1620601810)
(OE 993.111.993.00)
Rear sport exhaust set, "Sound Version", 2 pcs.
Polished stainless steel 304/4301



93.300SOE (1620608110)
(OE 993.111.993.00)
Rear sport exhaust set, OE style, 2 pcs.
Polished stainless steel 304/4301
With TÜV/EEC approval



93.013S (1623104670) left
(OE 993.211.039.10)
Heat exchanger "Gillet", OE style, Ø42 mm
outside
Polished stainless steel 304/4301



93.014S (1623104680) right
(OE 993.211.040.10)
Heat exchanger "Gillet", OE style, Ø42 mm
outside
Polished stainless steel 304/4301



93.400S (1620200110)
Cross pipe set, 2 pcs., Ø60 mm outside.
993 C2/C4/C4S with "Bischoff" exhaust system
replaces catalytic "Bischoff" converters. With
Lambda sensor hole and plug
Polished stainless steel 304/4301

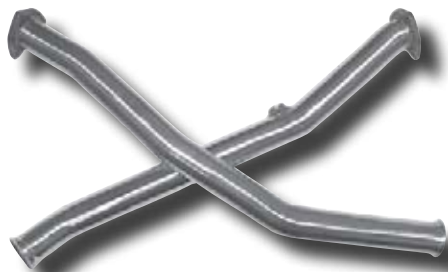

93.410S (1620200210)
Cross pipe set, 2 pcs., Ø60 mm outside.
993 C2/C4/C4S with "Gillet" exhaust system
replaces catalytic "Gillet" converters. With
Lambda sensor hole and plug
Polished stainless steel 304/4301



PO-93260S (1620300210)
Sport catalytic converter set, 100 cells
993 C2/C4/C4S. Fits both "Bischoff" and "Gillet"
systems
Polished stainless steel 304/4301

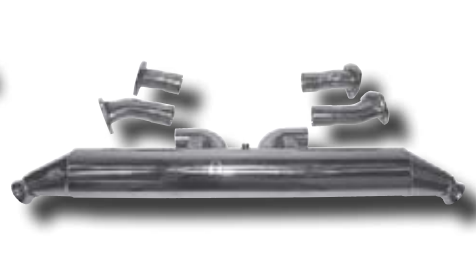

93.380S (1620301500)
Sport catalytic converter without catalytic
ceramic insert
993 C2/C4/C4S. Fits both "Bischoff" and "Gillet"
systems
Polished stainless steel 304/4301



Exhausts

911 C2/C4 (MODEL 993)

3.6 L, 1994-1998
Not turbo

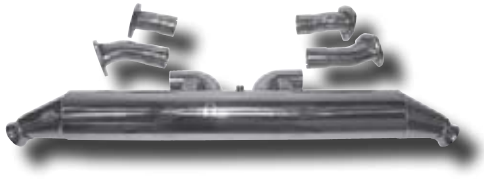

PO-93380S (1620300300)

Catalytic converter with catalytic ceramic insert,

100 cells

993 C2/C4/C4S. Fits both "Bischoff" and "Gillet"
systems

Polished stainless steel 304/4301



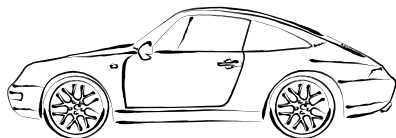

Mounting Kits & Tail Pipes

911 C2/C4 (MODEL 993)

3.6 L, 1994-1998

Not turbo



93.300KIT (1621700410)

Mounting kit for rear exhaust
993 C2 "Bischoff", 94-97
993 C4 "Bischoff", 95-97



93.301KIT (1621700510)

Mounting kit for rear exhaust
993 C2 "Gillet"/C2 S, 96-97
993 C4 "Gillet"/C4 S, 96-97



93.400KIT (1621701010)

Mounting kit for cross pipe set 93.400S
993 "Bischoff", 94-97



93.410KIT (1621701110)

Mounting kit for cross pipe set 93.410S
993 "Gillet", 94-97



93.901S (1620702110)

(OE 993.111.251.00/993.111.252.00)
Tail pipe set, clamp on type
993 C2/C4 (not C4 S)
Polished stainless steel 304/4301



93.903S (1620702310)

(OE 993.111.251.02/993.111.252.02)
Tail pipe set, clamp on type
993 C4 S
Polished stainless steel



93.904S (1620703310)

Tail pipe set, B-design, clamp on type
993 C2/C4 (not C4 S)
Polished stainless steel 304/4301



93.906S (1620701710)

Tail pipe set. Angle cut to follow the bumper
shape, clamp on type
993 C4 S
Polished stainless steel

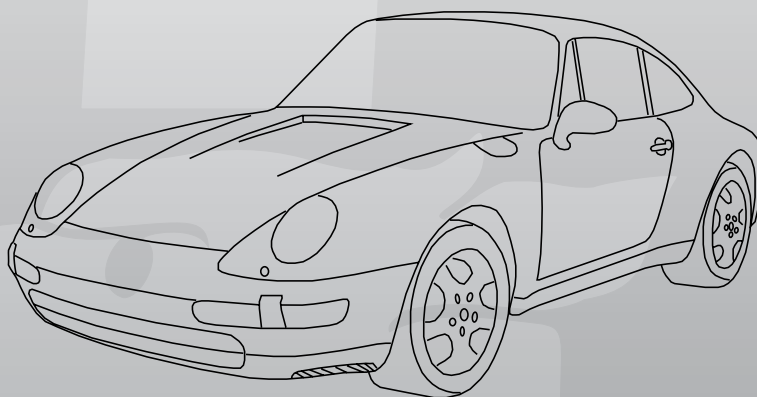

591041-1/591042-1

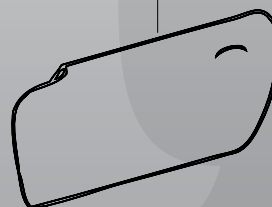



Body Parts

911 C2/C4 (MODEL 993)

3.6 L, 1994-1998

Not turbo



591041-1 (1680900270) left
(OE DAN.531.005.22)
Complete door skin
Painted galvanized steel

591042-1 (1680900280) right
(OE DAN.531.006.22)
Complete door skin
Painted galvanized steel

Exhausts

911 C2/C4 (MODEL 993)

3.6 L Turbo, 1994-1998

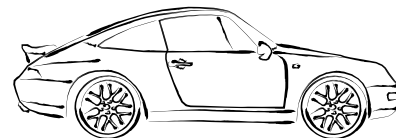

93.330S (1620601610)
(OE 993.111.045.01)
Rear sport exhaust set, 2 pcs.
Polished stainless steel 304/4301



P0-93360S (1620300710)
Sport catalytic converter set, 100 cells
Polished stainless steel 304/4301



P0-93360SX (1620300610)
Sport "dummy" catalytic converter set
Polished stainless steel 304/4301



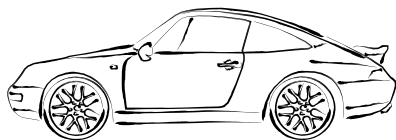

Mounting Kits & Tail Pipes

911 C2/C4 (MODEL 993)

3.6 L Turbo, 1994-1998



93.902CHR (1620703110)
(OE 993.111.251.01/993.111.252.01)
Tail pipe set, clamp on type
Chromed stainless steel 304/4301



93.902S (1620702210)
(OE 993.111.251.01/993.111.252.01)
Tail pipe set, clamp on type
Polished stainless steel 304/4301

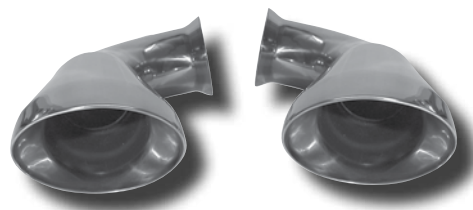

93.913S (1620700310)
Tail pipe set, bypass model. Replaces side
exhaust boxes, clamp on type
Polished stainless steel 304/4301

911 (MODEL 996)

3.4-3.6 L, 1998-2005

Not turbo

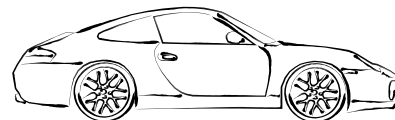

96.300S (1620601010)
Rear sport exhaust set
Polished stainless steel 304/4301
With TÜV/EEC approval



96.300SEXP (1620601110)
Rear sport exhaust set "Sound Version"
Polished stainless steel 304/4301

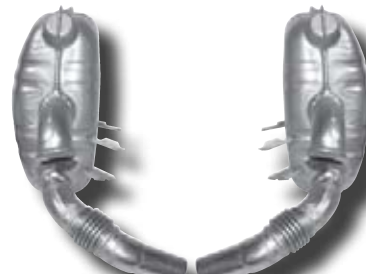

96.330S (1620602210)
(OE 996.111.210.00)
Rear sport exhaust set, OE style
Polished stainless steel 304/4301
With TÜV/EEC approval



96.335S-2 (1620609780) right
Rear exhaust, OE style
Polished stainless steel 304/4301
With TÜV/EEC approval



96.335S-1 (1620609770) left
Rear exhaust, OE style
Polished stainless steel 304/4301
With TÜV/EEC approval



96.335SSOUND (162061310)
Rear sport exhaust set, OE style, with adjustable
sound valves.
Polished stainless steel 304/4301



EQ253101 (1625002710)
Switch set for sound valves



96.260S (1620301710)
Catalytic pipes without catalytic ceramic insert
Stainless steel 304/4301



P0-96260S (1620301010)
Sport catalytic converter set, 100 cells
97-01
Polished stainless steel 304/4301



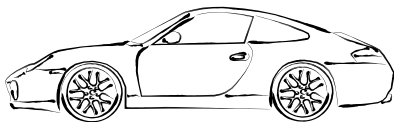

Exhausts

911 (MODEL 996)

3.4-3.6 L, 1998-2005

Not turbo

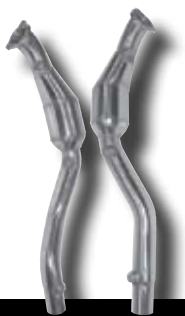

P0-96270S (1620301110)
Sport catalytic converter set, 200 cells
01-05
Polished stainless steel 304/4301



Mounting Kits & Tail Pipes

911 (MODEL 996)

3.4-3.6 L, 1998-2005

Not turbo

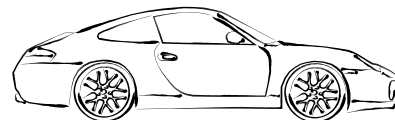

96.260KIT (1621701210)
Mounting kit for catalytic converter
Fits 96.260S, PO-96260S and PO-96270S



96.300KIT (1621700710)
Mounting kit for rear exhaust
Fits 96.300S, 96.300SEXP, 96.330S,
96.335S-1, 96.335S-2



96.901S (1620702410)
Tail pipe set, clamp on type
98-01
Polished stainless steel 304/4301



96.904S (1620703410)
Tail pipe set, Turbo look, clamp on type
98-01
Polished stainless steel 304/4301



96.911S (1620702510)
Tail pipe set, clamp on type
01-05
Polished stainless steel 304/4301



96.912S (1620703610)
Tail pipe set, Turbo look, clamp on type
01-05
Polished stainless steel 304/4301

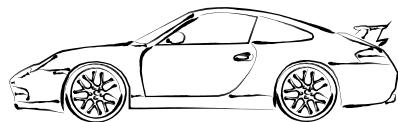

Exhausts

911 GT3 (MODEL 996)

1999-2005



96.300SGT3 (1620601210)

Rear sport exhaust set

Polished stainless steel 304/4301



Mounting Kits & Tail Pipes

911 GT3 (MODEL 996)

1999-2005

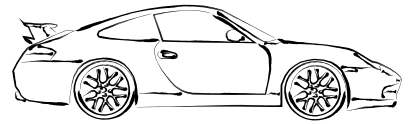

96.300KIT (1621700710)
Mounting kit for rear exhaust
Fits 96.300SGT3

96.911S (1620702510)
Tail pipe set, clamp on type
01-05
Polished stainless steel 304/4301

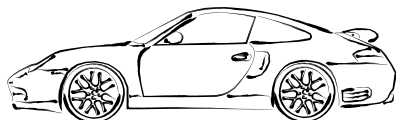

Exhausts

911 TURBO/GT2 (MODEL 996)

2001-2005



96.340S (1620800210)

Sport exhaust set including catalytic converters
(200 cells) and tail pipes
Polished stainless steel 304/4301

96.380S (1620100610)

Sport header set, Ø42 mm outside
Polished stainless steel 304/4301



Mounting Kits & Tail Pipes

911 TURBO/GT2 (MODEL 996)

2001-2005

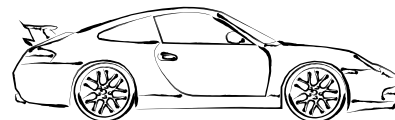

96.903S (1620702810)

Tail pipe set, clamp on type

Polished stainless steel 304/4301

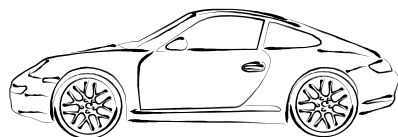

Exhausts

911 (MODEL 997-I)

2005-2008

Not turbo



97.300S (1620602110)

Rear sport exhaust set

Polished stainless steel 304/4301

For 3.8 L models. If used for 3.6 L models, also use tail pipe 97.901S

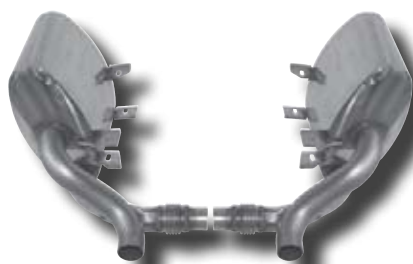

97.300SEXP (1620609810)

Rear sport exhaust set, "Sound Version"

Polished stainless steel 304/4301

For 3.8 L models. If used for 3.6 L models, also use tail pipe 97.901S



97.330S (1620601910)

Rear sport exhaust set, OE style

Polished stainless steel 304/4301

For 3.8 L models. If used for 3.6 L models, also use tail pipe 97.901S



97.330SEXP (1620602310)

Rear sport exhaust set, OE style, "Sound Version"

Polished stainless steel 304/4301

For 3.8 L models. If used for 3.6 L models, also use tail pipe 97.901S

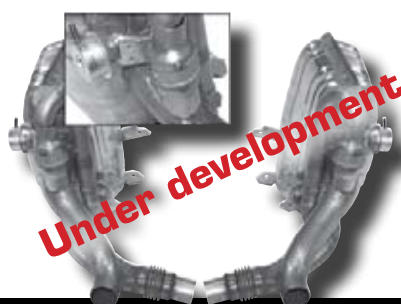

97.330SSOUND (1620610500)

Rear sport exhaust set, OE style, with adjustable sound valves.

Polished stainless steel 304/4301

For 3.8 L models. If used for 3.6 L models, also use tail pipe 97.901S



EQ253101 (1625002710)

Switch set for sound valves



97.220S (1620700210)

Bypass tail pipe set. Replaces the rear exhausts for an incredibly sound. To be installed directly on the catalytic converters

Polished stainless steel 304/4301

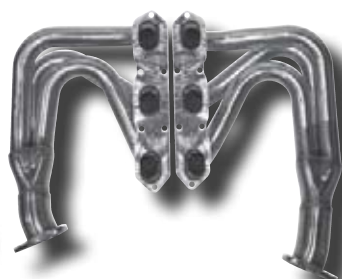

97.360S (1620100710)

Sport header system, Ø42 mm outside

Polished stainless steel 304/4301 use tail pipe



97.270S (1620301810)

Catalytic pipes without catalytic ceramic insert, Ø60 mm outside

Stainless steel 304/4301



Exhausts

911 (MODEL 997-I)

2005-2008
Not turbo

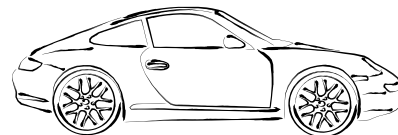

PO-97270S (1620301210)
Sport catalytic converter set, Tricat, 200 cells
Polished stainless steel 304/4301



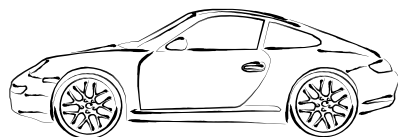

Mounting Kits & Tail Pipes

911 (MODEL 997-I)

2005-2008

Not turbo



97.270KIT (1621701310)
Mounting kit for catalytic pipes
Fits 97.270S and PO-97270S



97.330KIT (1621700810)
Mounting kit for rear exhaust
Fits 97.300S, 97.300SEXP, 97.330S,
97.330SEXP and 97.330SSOUND



97.901S (1620701810)
Tail pipe kit, "S" look (clamp on type)
Polished stainless steel
For 3.8 L models, For use on 3.6 L models, use
adaptor rings

Exhausts

911 TURBO (MODEL 997-I)

2007-2009

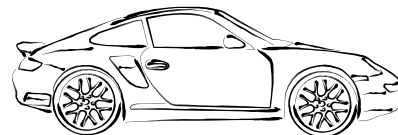

97.350S (1620801310)

Sport exhaust set including catalytic converters
(200 cells) and tail pipes
Polished stainless steel 304/4301

97.340SSOUND (1620801210)

Sport exhaust set including catalytic converters
(200 cells) and tail pipes, with adjustable sound
valves
Polished stainless steel 304/4301

EQ253101 (1625002710)

Switch set for sound valves



97.345S (1620602700)

Sport exhaust
Polished stainless steel 304/4301

97.380S (1620100810)

Sport header system, Ø42 mm outside
Polished stainless steel 304/4301



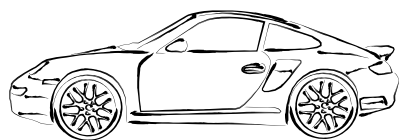

Mounting Kits & Tail Pipes

911 TURBO (MODEL 997-I)

2007-2009



97.904S (1620703010)

Tail pipe set, clamp on type

Polished stainless steel 304/4301

Exhausts

911 (MODEL 997-2)

2009-2011
Not turbo

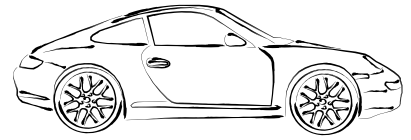

Under development

97.331S (1620602010)
Rear sport exhaust set, OE style
Polished stainless steel 304/4301

97.331SSOUND (1620801410)
Rear sport exhaust set, OE style, with adjustable
sound valves.
Polished stainless steel 304/4301



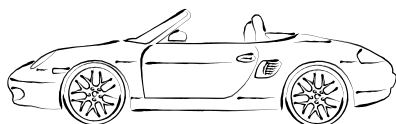

Exhausts

BOXSTER (986)

2.5-3.2 L, 1997-2004

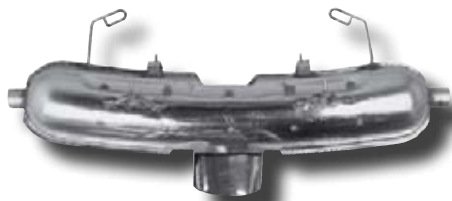

94.201S (1620603000)
(OE 996.111.121.05)
Sport exhaust with single tail pipe
Polished stainless steel 304/4301
2.5 L, 97-99
With TÜV/EEC approval

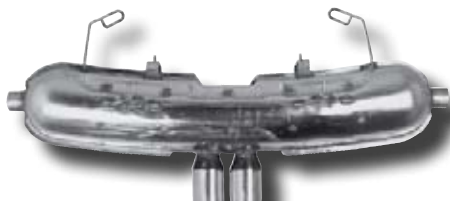

94.210S (1620603800)
(OE 996.111.121.10)
Sport exhaust with double tail pipes
Polished stainless steel 304/4301
2.5 L, 97-99
With TÜV/EEC approval



94.300S (1620606800)
Sport exhaust, OE style, without tail pipes (use
94.902S/94.903S/94.904S/94.905S/94.906S)
Polished stainless steel 304/4301
2.5 L, 97-99 (installation kit needed)
2.7-3.2 L, 99-04
With TÜV/EEC approval



94.300SEXP (1620600600)
Sport exhaust, OE style "Sound Version", without
tail pipes (use 94.90S/94.903S/94.904S/
94.905S/94.906S)
Polished stainless steel 304/4301
2.5 L, 97-99 (installation kit needed)
2.7-3.2 L, 99-04



94.301S (1620602900)
Sport exhaust with single oval tail pipe
Polished stainless steel 304/4301
2.5 L, 97-99 (installation kit needed)
2.7-3.2 L, 99-04
With TÜV/EEC approval



94.310S (1620602800)
Sport exhaust with double tail pipes
Polished stainless steel 304/4301
2.5 L, 97-99 (installation kit needed)
2.7-3.2 L, 99-04
With TÜV/EEC approval



94.330S (1620605200)
Sport exhaust, OE style, double loose tail pipes
(bolt on type)
Polished stainless steel 304/4301
2.5 L, 97-99 (installation kit needed)
2.7-3.2 L, 99-04
With TÜV/EEC approval



94.330SEXP (1620800700)
Sport exhaust, OE style, double loose tail pipes
(bolt on type), "Sound Version"
Polished stainless steel 304/4301
2.5 L, 97-99 (installation kit needed)
2.7-3.2 L, 99-04



94.331S (1620605100)
Sport exhaust, OE style, double loose tail pipes
(bolt on type), "Super Sound"
Polished stainless steel 304/4301
2.5 L, 97-99 (installation kit needed)
2.7-3.2 L, 99-04
With TÜV/EEC approval



BOXSTER (986)

2.5-3.2 L, 1997-2004

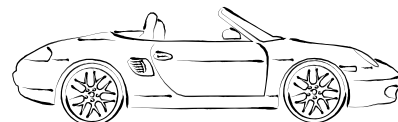

94.335S (1620600100)

Exhaust, OE style, double "S" tail pipe, "Standard Sound"

Polished stainless steel 304/4301

2.5 L, 97-99 (installation kit needed)

2.7-3.2 L, 99-04

With TÜV/EEC approval



94.335SSSOUND (1620610400)

Sport exhaust, OE style, double loose "S" tail pipe (bolt on type), with adjustable sound valves

Polished stainless steel 304/4301

2.5 L, 97-99 (installation kit needed)

2.7-3.2 L, 99-04

With TÜV/EEC approval



EQ253101 (1625002710)

Switch set for sound valves



94.280S (1620100210)

(OE 996.211.119.86)

Header system, Ø42 mm outside

Polished stainless steel 304/4301

2.5 L, 97-99



94.380S (1620100310)

(OE 996.111.103.00)

Header system, Ø42 mm outside

Polished stainless steel 304/4301

2.7-3.2 L, 99-04



94.290S (1620400510)

(OE 996.111.313.01)

Connecting tube set from exhaust to catalytic converter, Ø44 mm outside

Polished stainless steel 304/4301

2.5-3.2 L, 97-04



PO-94260S (1620300810)

(OE 996.113.921.01/922.01)

Sport catalytic converter set, 100 cells

Polished stainless steel 304/4301

2.5 L, 97-99



PO-94360S (1620300910)

Sport catalytic converter set, 100 cells

Polished stainless steel 304/4301

2.7-3.2 L, 99-04



94.260S (1620301910)

Pipe set, replacing the catalytic converters

Polished stainless steel 304/4301

2.5 L, 97-99



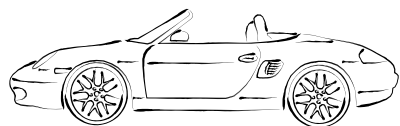

Exhausts

BOXSTER (986)

2.5-3.2 L, 1997-2004



94.360S (1620301610)

Pipe set, replacing the catalytic converters

Polished stainless steel 304/4301

2.7-3.2 L, 99-04



2.5-3.2 L, 1997-2004

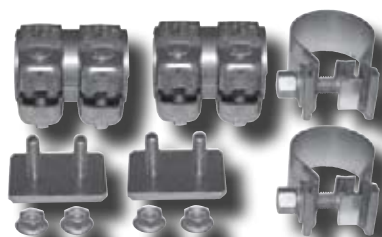
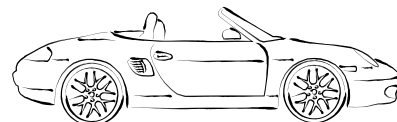

94.210KIT (1621700610)
Mounting kit for rear exhaust
2.5-3.2 L, 97-04



94.260KIT (1621700910)
Mounting kit for catalytic converter
2.5 L, 97-99



000.044.200.11 (1621700110)
Mounting kit for 2.7-3.2 L exhaust
2.5 L, 97-99



94.901S (1620700100)
Boxster S sound tail pipe (weld on type). 2 pcs.
needed
Polished stainless steel 304/4301
2.5-3.2 L, 97-04



94.902S (1620704500)
Tail pipe, triple look (bolt on type), Ø84/70 mm
For exhaust no. 94.300S
Polished stainless steel 304/4301
2.5-3.2 L, 97-04



94.903S (1620704400)
Tail pipe, "Super Sound" (bolt on type), Ø84 mm
For exhaust no. 94.300S
Polished stainless steel 304/4301
2.5-3.2 L, 97-04



94.904S (1620703900)
Tail pipe, double look (bolt on type), Ø80 mm
For exhaust no. 94.300S
Polished stainless steel 304/4301
2.5-3.2 L, 97-04



94.905S (1620704000)
Tail pipe, OE look (bolt on type), Ø95 mm
For exhaust no. 94.300S
Polished stainless steel 304/4301
2.5-3.2 L, 97-04



94.906S (1620705100)
Tail pipe, double look with alu ends (bolt on type)
For OE exhaust or 94.300S/94.300SEXP
Polished stainless steel 304/4301 with alu ends
2.5-3.2 L, 97-04



Exhausts

BOXSTER (987-I)/CAYMAN (987C-I)

2.7-3.4 L, 2005-2009

Standard and S model

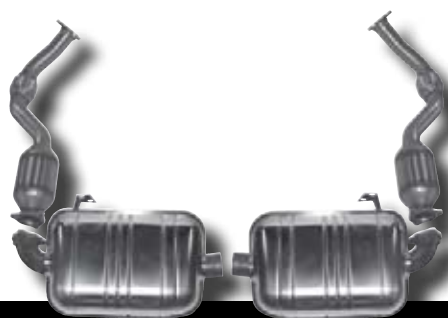

98.300S (1620602410)

Sport exhaust set with catalytic converters (200 cells)

Polished stainless steel 304/4301



98.301S (1620602510)

Sport exhaust set without catalytic converters

Polished stainless steel 304/4301



98.330SEXP (1620610600)

Sport exhaust without catalytic converters, "Sound Version"

Polished stainless steel 304/4301



Mounting Kits & Tail pipes

BOXSTER (987-I)/CAYMAN (987C-I)

2.7-3.4 L, 2005-2009

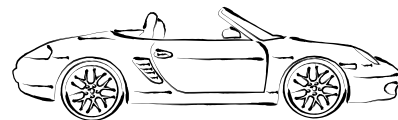

98.901S (1620704200)

Sport tail pipe, twin tube design, "S" look (bolt on type)

Polished stainless steel 304/4301



Exhausts

BOXSTER (987-II)/CAYMAN (987C-II)

2.7-3.4 L, 2009-2011

Standard and S model



98.310SPORT (1620601510)
Sport exhaust set
Polished stainless steel 304/4301



Exhausts

CAYENNE

3.2 L, 2004-2006

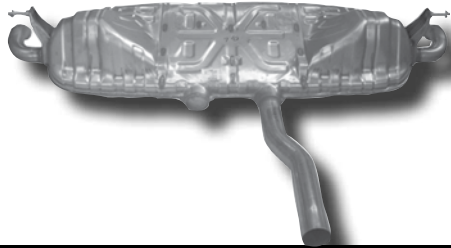

95.301 (1620610900)
(OE 955.111.121.30)
Sport exhaust without tail pipes
Aluminized steel



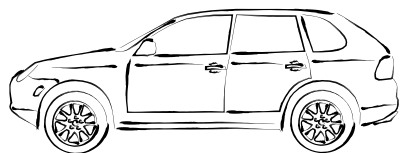

Exhausts

CAYENNE

4.5 L, 2003-2006

S model



95.300S (1620606100)
Sport exhaust without tail pipes
Polished stainless steel 304/4301



95.300SOE (1620611100)
Sport exhaust without tail pipes
Polished stainless steel 304/4301



CAYENNE

4.5 L, 2003-2006
S model

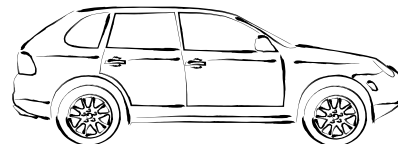

95.901S (1620702610) left/right
(OE 955.111.981.00/982.00)

Tail pipe kit, Turbo look, exclusive version (bolt
on type)

Polished stainless steel 304/4301

N.B.: Modifications needed to fit Cayenne S mo-
del: lower rear valance panel must be changed
to Turbo model version

95.902S (1620702710) left/right

Tail pipe kit, Turbo look, exclusive version (bolt
on type)

Polished stainless steel 304/4301

N.B.: Modifications needed to fit Cayenne S mo-
del: lower rear valance panel must be changed
to Turbo model version

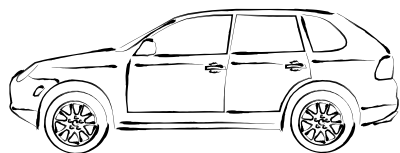

Exhausts

CAYENNE TURBO

4.5 L, 2003-2006

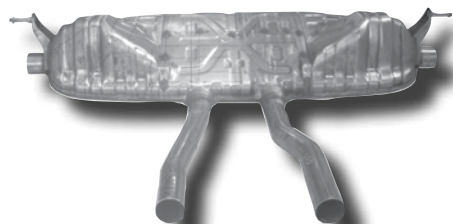

95.302 (1620611000)
Sport exhaust without tail pipes
Aluminized steel

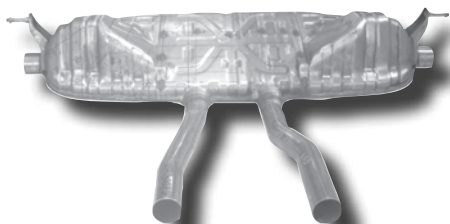

95.302S (1620611100)
Sport exhaust without tail pipes
Stainless steel 304/4301



Mounting Kits & Tail Pipes

CAYENNE TURBO

4.5 L, 2003-2006



95.901S (1620702610) left/right
(OE 955.111.981.00/982.00)
Tail pipe kit, Turbo look, exclusive version (bolt
on type)
Polished stainless steel 304/4301

95.902S (1620702710) left/right
Tail pipe kit, Turbo look, exclusive version (bolt
on type)
Polished stainless steel 304/4301

VARIOUS EXHAUST PARTS



80850 (1620900200)
Sport catalytic converter unit, 200 CPSI,
Ø130 mm



80869 (1620900500)
Sport catalytic converter unit, 100 CPSI,
Ø108 mm



80870 (1620900500)
Sport catalytic converter unit, 200 CPSI,
Ø108 mm



PO-98000 (1620900100)
Sport catalytic converter unit, 100 cells,
polished stainless steel 304/4301



PO-98000/200 (1620900300)
Sport catalytic converter unit, 200 cells,
polished stainless steel 304/4301



EQ253095 (1619900402)
Exhaust gas flap, Pierburg no. 7.28153.16.0
Height: 128.9 mm, Width: 124 mm
Flap Ø: 52 mm, Inner Ø: 55.6 mm
Outer Ø: 56 mm, Connection angle: 153°
Tube angle: 90°, Zero position: open



EQ253096 (1619900502)
Exhaust gas flap, Pierburg no. 7.28153.18.0
Height: 128.9 mm, Width: 124 mm
Flap Ø: 52 mm, Inner Ø: 55.6 mm
Outer Ø: 56 mm, Connection angle: 233°
Tube angle: 90°, Zero position: open



96.900S (1620704300)
Tail pipe, weld on type
Polished stainless steel 304/4301



EQ253101 (1625002710)
Switch set for sound valves



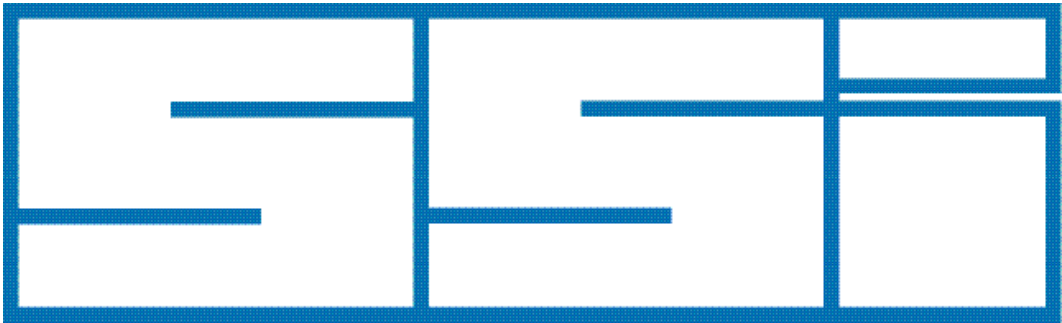



91.911SSI (1623104910)
Heat exchanger set, stainless steel, left/right
Europe:
Porsche® 911, 2.0-2.4, 64-74 (carb.), 69-71 (inj.)
Porsche® 911, 2.7, 74-76
Porsche® 911, 3.0, 78-83
USA:
Porsche® 911, 2.0-2.4, 66-71 (carb.), 69-71 (inj.)
Porsche® 911, 2.7, 75-76 Federal
Porsche® 911, 3.0, 78-79



91.913SSI (1623105010)
Heat exchanger set, stainless steel, left/right
Europe:
Porsche® 911, 2.2-2.4, 72-74 (inj.)
Porsche® 911 Carrera, 2.7, 74-76
USA:
Porsche® 911, 2.2-2.4, 72-74 (inj.)



91.915SSI (1623105110)
Heat exchanger set, stainless steel, left/right
USA:
Porsche® 911, 3.0 (Conversion*), 80-83
*For further details please see chart and text



91.917SSI (1623105210)
Heat exchanger set, stainless steel, left/right
Europe/USA:
Porsche® 911, 3.2 (Conversion*), 84-89
For this set oil pipes 911.107.729.10 and
911.107.739.10 are available from our
Dansk programme.



91.936SSI (1623105310)
Heat exchanger set, stainless steel, left/right
Europe/USA:
Porsche® 911, 3.6 (Conversion), installed in 65-89
chassis. Requires further modification to install.



91.914SSI (1623105410)
Heat exchanger set, stainless steel, left/right
Europe/USA:
Porsche® 914/4, 2.0, 72-75

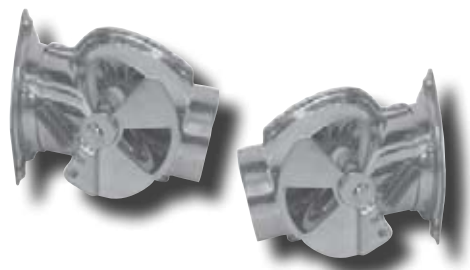

90.001SSI (1623200670) left
90.002SSI (1623200680) right
Heat control box, left or right, stainless steel



92.210SSI (1620611200)
Rear exhaust, Ø60 mm tail pipe, stainless steel
Porsche® 911, 2.0-2.4, 64-69



92.211SSI (1620611300)
Rear exhaust, Ø60 mm tail pipe, stainless steel
Porsche® 911, 2.7, 74-77

